

**GENERAL  
CATALOGUE 50 Hz**  
43.2019

**FAMCO**

**DAB**  
WATER • TECHNOLOGY



WATER BOOSTING



CONDITIONING



GARDENING & IRRIGATION



HEATING

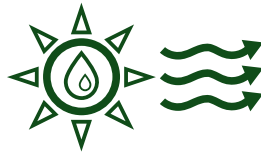

SOLAR PANELS



HOT WATER



WASTE WATER

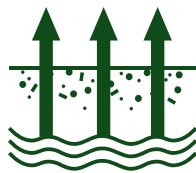

GROUND WATER



MACERATORS

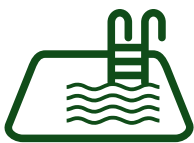

SWIMMING POOL



RAIN WATER REUSE



FIRE FIGHTING



IRRIGATION SYSTEMS



SALT WATER



PONDS AND FOUNTAINS

# MULTISTAGE CENTRIFUGAL AND SELF-PRIMING PUMPS

PERFORMANCE RANGE

## DP - DOMESTIC WATER SUPPLY

HYDRAULIC DATA (n ~ 2800 1/min.)																
MODEL	P2 NOMINAL		EJECTOR TYPE	SUCTION DEPTH	Delivery pressure in bar											
	kW	HP			1,5	2	2,5	3	3,5	4	4,5	5	5,5	6	6,5	7
					Capacity table in l/h											
DP 82 M - T	0,6	0,8	E 25	9 12 15	1813 1426 900	1080 225 326	446 - -	33 - -	- - -	- - -	- - -	- - -	- - -	- - -	- - -	
			E 30	9 12 15	1753 1345 1166	1286 965 761	812 608 452	524 329 228	261 162 45	12 0 -	- - -	- - -	- - -	- - -	- - -	- - -
DP 102 M - T	0,75	1	E 25	9 12 15	2386 1930 1459	1756 1190 773	1097 536 252	515 87 -	126 - -	- - -	- - -	- - -	- - -	- - -	- - -	
			E 30	12 15 18 21	- - - -	1240 1028 785 635	872 701 527 374	566 449 302 180	329 255 150 39	156 96 15 -	- - - -	- - - -	- - - -	- - - -	- - - -	
DP 151 M - T	1,1	1,5	E 20	9 12 15 18	- - - -	- - - -	- - - -	3470 3110 2710 2360	2890 2510 2100 1700	2220 1850 1380 950	1500 1100 640 -	750 300 -	- - - -	- - - -	- - - -	
			E 25	15 18 21	- - -	- - -	- - -	2800 2530 2280	2330 2050 1800	1830 1550 1300	1350 1090 860	900 680 470	520 300 -	- - -	- - -	- - -
			E 30	21 24 27	- - -	- - -	- - -	1820 1680 1550	1650 1520 1360	1410 1260 1110	1160 1020 880	910 780 680	700 580 490	520 420 330	- - -	- - -
DP 251 M - T	1,85	2,5	E 20	9 12 15 18	- - - -	- - - -	- - - -	4300 3750 -	3600 3140 2780 2340	2900 2540 2040 1610	2180 1700 1300 820	1400 940 500 -	640 -	- - -	- - -	
			E 25	15 18 21 24	- - - -	- - - -	- - - -	- -	2920 2600 2350 2050	2400 2110 1850 1550	1900 1620 1350 1080	1400 1150 900 660	950 720 510 300	570 360 -	- - -	- - -
			E 30	21 24 27	- - -	- - -	- - -	- -	- -	1710 1580 1440	1480 1330 1200	1220 1080 950	980 850 750	770 670 560	590 490 400	420 330 250

M - T = Single-phase (M) and Three-phase (T)

# DP

## PUMPS FOR DEEP SUCTION



DP 82-102



DP 151-251

Self-priming centrifugal pump for suction up to 27 metres, reached by means of an ejector. Cast iron pump body and motor support. Technopolymer impeller and diffusers. Stainless steel adjustment rings. Carbon/ceramic mechanical seal. Cast iron ejector body, technopolymer Venturi tube and brass nozzle. Asynchronous motor closed and cooled by external ventilation. Built-in thermal and current overload protection and a capacitor permanently on in the single-phase version. For the protection of the three-phase motor it is advisable to use a suitable overload protection complying with the regulations in force.

**Operating range** from 0.15 to 4.3 m<sup>3</sup>/h

**Liquid temperature range**

from 0°C to +40°C for other uses  
from 0°C to +35°C for domestic use

**Pumped liquid characteristics** clean, free from solids or abrasive substances, not viscous, not aggressive, not crystallised and chemically neutral.

**Maximum ambient temperature** +40°C

**Maximum working pressure**

6 bar (600 kPa) for DP 82 - DP 102  
8 bar (800 kPa) for DP 151 - DP 251

**Protection level** IP 44

**Insulation class** F

IE3 ≥ 0,75 kW

IE2 ≥ 0,75 kW

EXTRA EU

ACCESSORIES  
PAG. 109

MODEL	CODE	ELECTRICAL DATA					MOTOR TYPE	WEIGHT KG	Q.TY X PALLET
		VOLTAGE 50 Hz	P1 MAX KW	P2 NOMINAL		In A			
				KW	HP				
DP 82 M	102660860	1x220-240 V ~	0,73	0,6	0,8	3,4	-	10,7	28
DP 82 T	102660870	3x230-400 V ~	0,73	0,6	0,8	2,6-1,5	-	10,7	28
DP 102 M	102660880	1x220-240 V ~	0,79	0,75	1	3,8	-	13	28
DP 102 T	60179391	3x230-400 V ~	0,64	0,75	1	2,6-1,5	IE3	13	28
DP 151 M	102161042	1x220-240 V ~	1,56	1,1	1,5	7	-	28	21
DP 151 T	60179923	3x230-400 V ~	1,45	1,1	1,5	4,7-2,7	IE3	28	21
DP 251 M	102161072	1x220-240 V ~	-	1,85	2,5	8,3	-	32,5	21
DP 251 T	60179924	3x230-400 V ~	-	1,85	2,5	5,6-3,2	IE3	27,9	21
DP 102 T	60145174	3x230-400 V ~	0,64	0,75	1	2,6-1,5	IE2	13	28
DP 151 T	60145799	3x230-400 V ~	1,45	1,1	1,5	4,7-2,7		28	21
DP 251 T	60145851	3x230-400 V ~	-	1,85	2,5	5,6-3,2		27,9	21

## EJECTORS DP

MODEL	CODE	Q.TY X BOX
EJECTORS E 20	109200000	12
EJECTORS E 25	109200020	12
EJECTORS E 30	109200010	12

Don't provided with pump, to be ordered separately.



## INSTRUCTIONS FOR CONVERSION

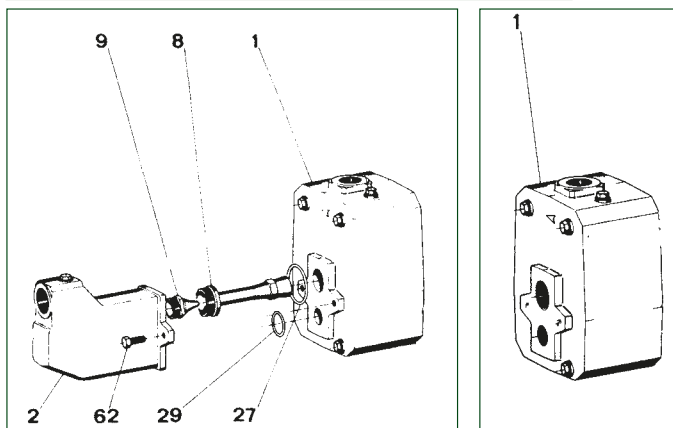

### Conversion from DP 151-251 to JET 151-251

Screw the nozzle (9) into place on the ejector's body (2) and the Venturi tube (8). Put the O-rings (27) and (29) in their respective places and fix the ejector body (2) to the pump body (1) using the two screws (62).

MODEL	CODE
EJECTOR JET 151 ASS.Y	R00009981
EJECTOR JET 251 ASS.Y	R00009983

### Conversion from JET 151-251 to DP 151-251

Loosen and remove the two screws (62) connecting the ejector body (2) to the pump body (1). Save the O-rings (27) and (29), the Venturi tube (8) and the nozzle (9).

# GARDENJET - GARDEN INOX - GARDEN COM

SELF-PRIMING CENTRIFUGAL PUMPS



GARDENJET



GARDEN-INOX



GARDEN-COM

Portable self-priming centrifugal electropump for gardening, vegetable gardens, washing and hobbies.

Equipped with a handle for easy transport and 2-metre power cable type H07 RN-F complete with plug and switch. Compact and easy to install, self-priming so that it can take up water from tanks, wells or streams, tolerating air bubbles and water with small particles of sand.

**Gardenjet:** Cast iron pump body and die-cast aluminium motor support.

**Garden-com:** Technopolymer pump body and die-cast aluminium motor support.

**Garden-inox:** Stainless steel pump body. Die-cast aluminium motor support.

Technopolymer impeller, diffuser and Venturi tube.

Stainless steel seal disc and pressure discs.

Carbon/ceramic mechanical seal.

Induction motor, closed and cooled with external ventilation.

Rotor mounted on oversized greased sealed-for-life ball bearings to ensure silent running and long life.

Built-in thermal and current overload protection and a capacitor permanently in circuit.

Manufactured according to CEI 2-3 and CEI 61-69 standards (EN 60335-2-41).

**Motor protection** IP 44

**Terminal box protection** IP 55

**Insulation class** F

**Standard voltage**

single-phase 220-240 V/50 Hz

**Operating range**

from 0.4 to 5.4 m<sup>3</sup>/h with head up to 54 metres.

**Liquid quality requirements** clean, free from solids or abrasive substances, non viscous, non aggressive, non crystalline neutral, close to the characteristics of water.

**Liquid temperature range**

from 0°C to +35°C for domestic use

(EN 60335-2-41)

from 0°C to +40°C for other uses

**Maximum ambient temperature** +40°C

**Maximum suction depth** 8 metres

**Maximum operating pressure**

8 bar (800 kPa)

6 bar (600 kPa) only for technopolymer models (JETCOM)

**Installation**

fixed or portable in a horizontal position.

Special executions on request: other voltages and/or frequencies.

ACCESSORIES  
PAG. 109

MODEL	CODE	ELECTRICAL DATA					HYDRAULIC DATA										DNA GAS	DNM GAS	WT. KG	Q.TY X PALLET
		VOLTAGE 50 Hz	P1 MAX KW	P2 NOMINAL		In A	Q=m <sup>3</sup> /h	0	0,6	1,2	1,8	2,4	3,0	3,6	4,2	4,8				
				KW	HP															
GARDENJET 82 M	102652010	1x220-240 V ~	0,85	0,6	0,8	3,8	H (m)	47	40	34	30	26,2	23,5	20,3			1"	1"	11	28
GARDENJET 102 M	102652020	1x220-240 V ~	1,13	0,75	1	5,1		53,8	47	41	36,3	32,4	28,8	25,8			1"	1"	12,8	28
GARDENJET 132 M	102652040	1x220-240 V ~	1,49	1	1,36	6,6		48,3	45,6	42,8	40	37,6	35	32,5	30	27,2	1"	1"	13,8	28
GARDEN-INOX 82 M	102657010	1x220-240 V ~	0,85	0,6	0,8	3,8		47	40	34	30	26,2	23,5	20,3			1"	1"	10,7	28
GARDEN-INOX 102 M	102657020	1x220-240 V ~	1,13	0,75	1	5,1		53,8	47	41	36,3	32,4	28,8	25,8			1"	1"	12,5	28
GARDEN-INOX 132 M	102657040	1x220-240 V ~	1,49	1	1,36	6,6		48,3	45,6	42,8	40	37,6	35	32,5	30	27,2	1"	1"	13,5	28
GARDEN-COM 62 M	102682000	1x220-240 V ~	0,72	0,44	0,6	3,12		42,7	35	29,2	25,6	22,9	13				1"	1"	10,7	28
GARDEN-COM 82 M	102682010	1x220-240 V ~	0,85	0,6	0,8	3,8		47	40	34	30	26,2	23,5	20,3			1"	1"	10,7	28
GARDEN-COM 102 M	102682020	1x220-240 V ~	1,13	0,75	1	5,1		53,8	47	41	36,3	32,4	28,8	25,8			1"	1"	12,5	28

# EURO - EUROINOX - EUROCOM

## MULTISTAGE CENTRIFUGAL PUMPS



EURO



EUROINOX



EUROCOM

Multistage horizontal centrifugal pump, featuring extremely silent running suitable for domestic use for water supply and pressurisation, irrigation of gardens and vegetable gardens, and moving water in general.

**Euro:** pump body in 200 UNI ISO 185 cast iron.

**Euroinox:** stainless steel pump body.

**Eurocom:** technopolymer pump body.

Motor support in die-cast aluminium, seal holder in AISI 304 steel. Mechanical seal in carbon/ceramic. Rotor shaft in AISI 304 steel. Rotors, diffuser bodies and diffusers in technopolymer. Adjustment rings in stainless steel.

**Protection level of motor** IP 44

**Protection level of terminal board** IP 55

**Insulation class** F

**Operating range** from 10 to 120 l/min. with a head of up to 72 m.

**Pumped liquid characteristics** clean, free from solid or abrasive substances, not viscous, not aggressive, not crystallised, chemically neutral and close to the characteristics of water.

**Liquid temperature range**

from 0°C to +35°C C for domestic use (EN 60335-2-41)

from 0°C to +40°C for other uses.

**Maximum ambient temperature** +40°C

**Maximum operating pressure** 8 bar (800 kPa)

**Euroinox self-priming**, other uses.

**Maximum ambient temperature** +40°C

**Maximum operating pressure** 8 bar (800 kPa)

**Euroinox** self-priming.

**IE3 ≥ 0,75 kW**

**IE2 ≥ 0,75 kW**

**EXTRA EU**

**ACCESSORIES  
PAG. 109**

## EURO

MODEL	CODE	ELECTRICAL DATA					HYDRAULIC DATA												N° IMPELLERS	DNA GAS	DNM GAS	WT. KG	Q.TY x PALLET	
		VOLTAGE 50 Hz	P1 MAX KW	P2 NOMINAL		In A	MOTOR TYPE	Q=m³h	0	0,6	1,2	1,8	2,4	3,0	3,6	4,2	4,8	6						7,2
				Q=l/min	0			10	20	30	40	50	60	70	80	100	120							
<b>EURO 25/30 M</b>	102970000	1x220-240 V ~	0,510	0,37	0,5	2,4	-	34,4	31,7	28,3	23,5	17,5	11							3	1"	1"	10,7	28
<b>EURO 30/30 M</b>	60169377	1x220-240 V ~	0,74	0,45	0,6	3,2	-	46	42,2	37,8	31,2	23,3	14,3							4	1"	1"	12,7	28
<b>EURO 40/30 M</b>	102970040	1x220-240 V ~	0,870	0,55	0,75	3,9	-	57	52,7	47	38,8	29	17,7							5	1"	1"	12,8	28
<b>EURO 30/50 M</b>	102970060	1x220-240 V ~	0,880	0,55	0,75	3,9	-	42,5	40,2	38,2	36,2	33,8	30	24,8	19,5	14				3	1"	1"	11,7	28
<b>EURO 40/50 M</b>	102970080	1x220-240 V ~	1,200	0,75	1	5,3	-	57,5	55,3	52,8	50,1	47,1	42,7	35,8	28	19				4	1"	1"	15,6	28
<b>EURO 40/50 T</b>	60179428	3x230-400 V ~	1,180	0,75	1	3,8/2,2	<b>IE3</b>	57,5	55,3	52,8	50,1	47,1	42,7	35,8	28	19				4	1"	1"	15,6	28
<b>EURO 50/50 M</b>	102970100	1x220-240 V ~	1,480	1	1,36	6,3	-	72	68,5	65,5	62,1	58,2	52,2	43,6	34,5	26				5	1"	1"	16,2	28
<b>EURO 50/50 T</b>	60179426	3x230-400 V ~	1,440	1	1,36	4,4/2,5	<b>IE3</b>	72	68,5	65,5	62,1	58,2	52,2	43,6	34,5	26				5	1"	1"	16,2	28
<b>EURO 30/80 M</b>	102970140	1x220-240 V ~	1,2	0,8	1,1	5,3	-	47	46,5	45	43,5	41	38	34,5	31	23	12			4	1"	1"	15,6	28
<b>EURO 30/80 T</b>	60179424	3x230-400 V ~	1,18	0,8	1,1	3,8/2,2	<b>IE3</b>	47	46,5	45	43,5	41	38	34,5	31	23	12			4	1"	1"	15,6	28
<b>EURO 40/80 M</b>	102970160	1x220-240 V ~	1,48	1	1,36	6,3	-	59	57	56	54	51	47	43,5	39	29,5	16,5			5	1"	1"	16,2	28
<b>EURO 40/80 T</b>	60179422	3x230-400 V ~	1,44	1	1,36	4,4/2,5	<b>IE3</b>	59	57	56	54	51	47	43,5	39	29,5	16,5			5	1"	1"	16,2	28
<b>EURO 40/50 T</b>	60145283	3x230-400 V ~	1,180	0,75	1	3,8/2,2	<b>IE2</b>	57,5	55,3	52,8	50,1	47,1	42,7	35,8	28	19				4	1"	1"	15,6	28
<b>EURO 50/50 T</b>	60145284	3x230-400 V ~	1,440	1	1,36	4,4/2,5		72	68,5	65,5	62,1	58,2	52,2	43,6	34,5	26				5	1"	1"	16,2	28
<b>EURO 30/80 T</b>	60145285	3x230-400 V ~	1,18	0,8	1,1	3,8/2,2		47	46,5	45	43,5	41	38	34,5	31	23	12			4	1"	1"	15,6	28
<b>EURO 40/80 T</b>	60145286	3x230-400 V ~	1,44	1	1,36	4,4/2,5		59	57	56	54	51	47	43,5	39	29,5	16,5			5	1"	1"	16,2	28

# EURO - EUROINOX - EUROCOM

MULTISTAGE CENTRIFUGAL PUMPS



IE3 ≥ 0,75 kW

IE2 ≥ 0,75 kW

EXTRA EU

## EUROINOX

MODEL	CODE	ELECTRICAL DATA						HYDRAULIC DATA														N° IMPELLERS	DNA GAS	DNM GAS	WT. KG	Q.TY x PALLET	
		VOLTAGE 50 Hz	P1 MAX KW	P2 NOMINAL		In A	MOTOR TYPE	Q=m³h	0	0,6	1,2	1,8	2,4	3,0	3,6	4,2	4,8	6	7,2								
				Q=l/min	0			10	20	30	40	50	60	70	80	100	120										
EUROINOX 25/30 M	102970200	1x220-240 V ~	0,520	0,37	0,5	2,4	-	H (m)	34	31,7	28,3	23,5	17,5	11							3	1"	1"	9,7	28		
EUROINOX 30/30 M	102970220	1x220-240 V ~	0,720	0,45	0,6	3,2	-		46	42,2	37,8	31,2	23,3	14,3								4	1"	1"	11,7	28	
EUROINOX 40/30 M	102970240	1x220-240 V ~	0,880	0,55	0,75	3,9	-		57	52,7	47	38,8	29	17,7								5	1"	1"	11,9	28	
EUROINOX 30/50 M	102970260	1x220-240 V ~	0,880	0,55	0,75	3,9	-		42	40,2	38,2	36,2	33,8	30	24,8	19,5	14					3	1"	1"	10,5	28	
EUROINOX 30/50 T	102970270	3x230-400 V ~	0,870	0,55	0,75	2,8-1,6	-		42	40,2	38,2	36,2	33,8	30	24,8	19,5	14					3	1"	1"	10,5	28	
EUROINOX 40/50 M	102970280	1x220-240 V ~	1,200	0,75	1	5,3	-		58	55,3	52,8	50,1	47,1	42,7	35,8	28	19					4	1"	1"	14,6	28	
EUROINOX 40/50 T	60179419	3x230-400 V ~	1,180	0,75	1	3,8-2,2	IE3		58	55,3	52,8	50,1	47,1	42,7	35,8	28	19					4	1"	1"	14,6	28	
EUROINOX 50/50 M	102970300	1x220-240 V ~	1,480	1	1,36	6,3	-		72	68,5	65,5	62,1	58,2	52,2	43,6	34,5	26					5	1"	1"	15,1	28	
EUROINOX 50/50 T	60179421	3x230-400 V ~	1,440	1	1,36	4,4-2,5	IE3		72	68,5	65,5	62,1	58,2	52,2	43,6	34,5	26					5	1"	1"	15,1	28	
EUROINOX 30/80 M	102970340	1x220-240 V ~	1,200	0,8	1,1	5,3	-		47	46,5	45	43,5	41	38	34,5	31	23	12				4	1"	1"	14,6	28	
EUROINOX 30/80 T	60179423	3x230-400 V ~	1,18	0,8	1,1	3,8-2,2	IE3		47	46,5	45	43,5	41	38	34,5	31	23	12				4	1"	1"	14,6	28	
EUROINOX 40/80 M	102970360	1x220-240 V ~	1,48	1	1,36	6,5	-		59	57	56	54	51	47	43,5	39	29,5	16,5				5	1"	1"	15,1	28	
EUROINOX 40/80 T	60179418	3x230-400 V ~	1,44	1	1,36	4,4-2,5	IE3		59	57	56	54	51	47	43,5	39	29,5	16,5				5	1"	1"	15,1	28	
EUROINOX 40/50 T	60145287	3x230-400 V ~	1,180	0,75	1	3,8-2,2	IE2		H (m)	58	55,3	52,8	50,1	47,1	42,7	35,8	28	19				4	1"	1"	14,6	28	
EUROINOX 50/50 T	60145288	3x230-400 V ~	1,440	1	1,36	4,4-2,5				72	68,5	65,5	62,1	58,2	52,2	43,6	34,5	26					5	1"	1"	15,1	28
EUROINOX 30/80 T	60145289	3x230-400 V ~	1,18	0,8	1,1	3,8-2,2				47	46,5	45	43,5	41	38	34,5	31	23	12				4	1"	1"	14,6	28
EUROINOX 40/80 T	60145290	3x230-400 V ~	1,44	1	1,36	4,4-2,5				59	57	56	54	51	47	43,5	39	29,5	16,5				5	1"	1"	15,1	28

## EUROCOM

MODEL	CODE	ELECTRICAL DATA						HYDRAULIC DATA														N° IMPELLERS	DNA GAS	DNM GAS	WT. KG	Q.TY x PALLET
		VOLTAGE 50 Hz	P1 MAX KW	P2 NOMINAL		In A	MOTOR TYPE	Q=m³h	0	0,6	1,2	1,8	2,4	3,0	3,6	4,2	4,8	6	7,2							
				Q=l/min	0			10	20	30	40	50	60	70	80	100	120									
EUROCOM 25/30 M	102960000	1x220-240 V ~	0,520	0,37	0,5	2,4	-	H (m)	34,4	31,7	28,3	23,5	17,5	11							3	1"	1"	8	28	
EUROCOM 30/50 M	102960060	1x220-240 V ~	0,880	0,55	0,75	3,9	-		42,2	40,2	38,2	36,2	33,8	30	24,8	19,5	14					3	1"	1"	8,8	28
EUROCOM 40/50 M	102960080	1x220-240 V ~	1,200	0,75	1	5,3	-		57,7	55,3	52,8	50,1	47,1	42,7	35,8	28	19,2					4	1"	1"	11	28
EUROCOM 40/50 T	60179427	3x230-400 V ~	1,180	0,75	1	3,8-2,2	IE3		57,7	55,3	52,8	50,1	47,1	42,7	35,8	28	19,2					4	1"	1"	11	28
EUROCOM 30/80 T	60179425	3x230-400 V ~	1,040	0,8	1,1	3,3-1,9			47	46,5	45	43,5	41	38	34,5	31	23	12				4	1"	1"	11	28
EUROCOM 40/50 T	60145279	3x230-400 V ~	1,180	0,75	1	3,8-2,2	IE2	H (m)	57,7	55,3	52,8	50,1	47,1	42,7	35,8	28	19,2				4	1"	1"	11	28	
EUROCOM 30/80 T	60145280	3x230-400 V ~	1,040	0,8	1,1	3,3-1,9			47	46,5	45	43,5	41	38	34,5	31	23	12				4	1"	1"	11	28

# MULTI INOX

## SELF-PRIMING HORIZONTAL MULTISTAGE PUMPS



Self-priming multistage pumps ideal for water supply in domestic and garden applications. High performances. Available with 3 - 4 - 5 **impellers in AISI 304 stainless steel**.  
Materials resistant to corrosion and oxidation.  
Motor with thermal overload protection.  
Double insulation between motor and hydraulic section.  
Optimal resistance to low temperatures.  
Supplied complete with power cable and plug.

### Liquid temperature range

from 0°C to +35°C (for domestic use)  
(EN 60335-2-41)  
from 0°C to +40°C (for other uses).

ACCESSORIES  
PAG. 109

MODEL	CODE	ELECTRICAL DATA				HYDRAULIC DATA										N° IMPELLERS	DNA GAS	DNM GAS	WT. KG	Q.TY X PALLET		
		VOLTAGE 50 Hz	P1 MAX KW	P2 NOMINAL		In A	Q=m³h	0	0,6	1,2	1,8	2,4	3,0	3,6	4,2						4,8	5,4
MULTI INOX 3 M	60122692	1x220-240 V ~	0,80	0,55	0,75	3,7	Q=l/min	0	10	20	30	40	50	60	70	80	90	3	1"	1"	8,8	21
MULTI INOX 4 M	60122693	1x220-240 V ~	1,00	0,75	1	4,5	H (m)	46	45	43	40	38	33	28	22	16	9	4	1"	1"	11,3	21
MULTI INOX 5 M	60122694	1x220-240 V ~	1,25	1	1,36	5,5	H (m)	59	58	56	53	49	45	38	32	25	13	5	1"	1"	12,5	21

# ACTIVE SYSTEM

ON/OFF AUTOMATIC ELECTRONIC BOOSTER SYSTEMS



ACTIVE J



ACTIVE EI

Automatic lifting units, particularly suitable for domestic use, small systems for civil, agricultural and industrial use, washing systems and hobby applications.

They are characterised by the use of:

- self-priming motor-driven pumps JET, JETINOX, EUROINOX that can even work when there are bubbles of air or gas. They are essential for drawing from artesian wells or wherever suction difficulties arise. The EURO - EUROCOM multistage centrifugal pumps are particularly appropriate for low-noise underwater operation.

The **ACTIVE** system helps increase pressure in systems where it is insufficient or irregular.

The **ACTIVE** system is a built-in, easy-to-install, and ready-to-use device which:

- controls it
- commands it automatically
- controls its operation
- limits starts
- guarantees pressure stability inside the hydraulic circuit.
- electronically controls starting pressure

## Operating range

from 0.4 to 4.8 m<sup>3</sup>/h with head up to 57 metres.

Liquid quality requirements: clean, free from solid or abrasive contaminants, non-viscous, non-aggressive, uncrystallised and chemically neutral, close to the properties of water.

**Liquid temperature range** from 0°C to +35°C for domestic use (EN 60335-2-41).

For other use: from 0°C to +40°C

**Maximum ambient temperature** +40°C

**Maximum operating pressure** 8 bar (800 kPa)

**Installation** fixed in a horizontal position.

**Special executions on request** different frequencies and/or voltage.

**Motor protection rating** IP 44

**Terminal block protection rating** IP 55

**Insulation class** F

**Standard input voltage**

single phase 220/240 V / 50 Hz

three phase 230/400 V - 50 Hz

MODEL	CODE	ELECTRICAL DATA				HYDRAULIC DATA												DNA GAS	DNM GAS	WEIGHT KG	Q.TY X PALLET	
		VOLTAGE 50 Hz	P1 MAX KW	P2 NOMINAL		In A	Q=m <sup>3</sup> /h															
				KW	HP		0	0,6	1,2	1,8	2,4	3,0	3,6	4,2	4,8	6	7,2					
ACTIVE J 82 M	102690010	1x220-240 V ~	0,85	0,6	0,8	3,8	47	40	34	30	26,2	23,5	20,3						1"	1"	13,2	14
ACTIVE J 102 M	102690020	1x220-240 V ~	1,13	0,75	1	5,1	53,8	47	41	36,3	32,4	28,8	25,8						1"	1"	12,5	14
ACTIVE J 132 M	102690050	1x220-240 V ~	1,49	1	1,36	6,6	48,3	45,6	42,8	40	37,6	35	32,5	30	27,2				1"	1"	13,5	14
ACTIVE JI 82 M	102690210	1x220-240 V ~	0,85	0,6	0,8	3,8	47	40	34	30	26,2	23,5	20,3						1"	1"	10,7	14
ACTIVE JI 102 M	102690220	1x220-240 V ~	1,13	0,75	1	5,1	53,8	47	41	36,3	32,4	28,8	25,8						1"	1"	12,5	14
ACTIVE JI 132 M	102690250	1x220-240 V ~	1,49	1	1,36	6,6	48,3	45,6	42,8	40	37,6	35	32,5	30	27,2				1"	1"	13,5	14
ACTIVE JC 102 M	102690420	1x220-240 V ~	1,13	0,75	1	5,1	53,8	47	41	36,3	32,4	28,8	25,8						1"	1"	12,5	14
ACTIVE JC 132 M	102690450	1x220-240 V ~	1,49	1	1,36	6,6	48,3	45,6	42,8	40	37,6	35	32,5	30	27,2				1"	1"	13,5	14
ACTIVE EI 30/50 M	102690830	1x220-240 V ~	0,88	0,55	0,75	3,9	42,2	40,2	38,2	36,2	33,8	30	24,8	19,5	14				1"	1"	10,0	14
ACTIVE EI 40/50 M	102690840	1x220-240 V ~	1,20	0,8	1,1	5,3	57,7	55,3	52,8	50,1	47,1	42,7	35,8	28	19,2				1"	1"	15,5	14
ACTIVE EI 50/50 M	102690850	1x220-240 V ~	1,48	1	1,36	6	72	68,5	65,5	62,1	58,2	52,2	48	43,6	34,5	26			1"	1"	15,2	14
ACTIVE EI 25/80 M	102690860	1x220-240 V ~	0,880	0,55	0,75	3,9	34		33	32	30,5	28,5	26	23,5	21	14,5	6,5		1"	1"	9,5	14
ACTIVE EI 40/80 M	102690880	1x220-240 V ~	1,48	1	1,36	6	59	58	57	56	54	51	47,5	43,8	39,5	29,5	16		1"	1"	15	14

## INCLUDED ACCESSORIES

MODEL
ACTIVE FLEXIBLE PIPE FOR HYDRAULIC CONNECTION



ACTIVE FLEXIBLE PIPE

# KPA

## SELF-PRIMING PERIPHERAL PUMPS



Self-priming peripheral pump with star impeller, with a great suction capacity. Cast iron body with brass ring. Motor support and impeller in brass to avoid the risk of blocking. Driving shaft in stainless steel. Carbon/ceramic mechanical seal. Asynchronous, closed motor, cooled by external ventilation. Built-in thermal and current overload protection and a capacitor permanently on in the single-phase version. For the protection of the three-phase motor it is advisable to use a suitable overload protection complying with the regulations in force.

### Operating range

from 8 to 45 l/min. with head up to 53 metres.

### Liquid temperature range

from -10°C to +80°C  
from 0°C to +35°C for domestic use.

**Pumped liquid characteristics** clean, free from solids or abrasive substances, not viscous, not aggressive, not crystallised and chemically neutral.

**Maximum ambient temperature** +40°C

**Maximum working pressure** 10 bar (1000 kPa).

### Protection level

IP 44 (IP 55 terminal board protection).

**Insulation class** F

IE3 ≥ 0,75 kW

IE2 ≥ 0,75 kW

EXTRA EU

MODEL	CODE	ELECTRICAL DATA						HYDRAULIC DATA								DNA	DNM	Weight Kg	Q.TY x PALLET
		VOLTAGE 50 Hz	P1 MAX kW	P2 NOMINAL		In A	MOTOR TYPE	Q=m³h	0	0,3	0,6	0,9	1,2	1,8	2,4				
				Q=l/min	0			5	10	15	20	30	40						
KPA 40/20 M	101120000	1 x 230 V ~	1,1	0,75	1	5,1	-	H (m)	53	51	48	43	38	27	16	1°G	1°G	12,40	39
KPA 40/20 T	60180169	3 x 230 - 400 V ~	1	0,75	1	3,5-2,1	IE3		53	51	48	43	38	27	16	1°G	1°G	12,40	39
KPA 40/20 T	60145185	3 x 230 - 400 V ~	1	0,75	1	3,5-2,1	IE2	H (m)	53	51	48	43	38	27	16	1°G	1°G	12,40	39

# KPS - KPF - KP

## PERIPHERAL PUMPS



Peripheral centrifugal pump, reduced encumbrance, able to generate high heads, it is suitable for domestic use and small industrial uses. Pump body and motor support in brass for the KP 60 version, in cast iron for the KPS 30 and KP 38 versions. Brass impeller. Mechanical seal in carbon/ceramic. Asynchronous, closed motor, cooled by external ventilation. Built-in thermal and current overload protection and a capacitor permanently on in the single-phase version. For the protection of the three-phase motor it is advisable to use a suitable overload protection complying with the regulations in force.

### Operating range

from 1 to 50 l/min. with head up to 107 metres.

### Liquid temperature range

from 0°C to +35°C for domestic use.  
from -10°C to +50°C for other uses.

**Pumped liquid characteristics** clean, free from solids or abrasive substances, not viscous, not aggressive, not crystallised and chemically neutral.

**Maximum ambient temperature** +40°C

**Maximum working pressure** 10 bar (6 bar for KPS-KPF 30/16).

**Protection level** IP 44

**Insulation class** F

IE3 ≥ 0,75 kW

IE2 ≥ 0,75 kW

EXTRA EU

MODEL	CODE	ELECTRICAL DATA						HYDRAULIC DATA								DNA	DNM	WEIGHT Kg	Q.TY x PALLET
		VOLTAGE 50 Hz	P1 MAX kW	P2 NOMINAL		In A	MOTOR TYPE	Q=m³h	0	0,3	0,6	0,9	1,2	1,8	2,4				
				Q=l/min	0			5	10	15	20	30	40						
KPF 30/16 M	101110400	1 x 230 V ~	0,53	0,37	0,5	2,37	-	H (m)	32,5	31	25	22	17,5	10		1°G	1°G	5,3	110
KPF 30/16 T	101110410	3 x 230 - 400 V ~	0,47	0,37	0,5	1,45-0,82	-		32,5	31	25	22	17,5	10		1°G	1°G	5,3	110
KPS 30/16 M	101110024	1 x 230 V ~	0,47	0,37	0,5	2	-		32,5	31	25	22	17,5	10		1°G	1°G	5,4	120
KPS 30/16 T	101110014	3 x 230 - 400 V ~	0,47	0,37	0,5	1,4-0,8	-		32,5	31	25	22	17,5	10		1°G	1°G	5,4	120
KPS 30/16 M-P	101112224	1 x 230 V ~	0,47	0,37	0,5	2	-		32,5	31	25	22	17,5	10		1°G	1°G	5,4	36
KP 38/18 M	101110060	1 x 230 V ~	0,89	0,6	0,8	4	-		54	50	46	41	36	27,5	17,5	1°G	1°G	7,5	68
KP 38/18 T	101110050	3 x 230 - 400 V ~	0,86	0,6	0,8	2,9-1,7	-		54	50	46	41	36	27,5	17,5	1°G	1°G	7,5	68
KPF 45/20 M	60141934	1 x 230 V ~	1,5	1,0	1,34	5,9	-		84	76	68	62	56	38	24	1°G	1°G	9,0	39
KPF 45/20 T	60179405	3 x 230 - 400 V ~	1,4	1,0	1,34	-	IE3		84	76	68	62	56	38	24	1°G	1°G	9,0	39
KPF 45/20 T	60145268	3 x 230 - 400 V ~	1,4	1,0	1,34	-	IE2		H (m)	84	76	68	62	56	38	24	1°G	1°G	9,0

<sup>1</sup> KPS-fitted Pump fitted with a pressure gauge, pressure switch, power supply cable with plug and five-way fitting for connection to a tank.

# KP

## PERIPHERAL PUMPS



Pump body, motor support and impeller in brass. Carbon/ceramic mechanical seal. Stainless steel motor shaft. Asynchronous, closed motor cooled by external ventilation. Rotor mounted on oversized greased sealed-for-life ball bearings to ensure silent running and long life. Motor overload cut out equipped as standard in the single-phase version. Overload protection to be provided by the user for the three-phase version. Permanently connected capacitor for the single-phase version. Construction to CEI 2-3 and CEI 61-69 (EN 60335-2-41)

**Protection rating** IP 44

**Insulation class** F

**Standard voltage**

1x230V 50Hz single-phase  
3x230-400V 50Hz three-phase

**Operating range**

from 1 to 35 l/min with head up to 107 meters.

**Pumped liquid** clean, free from solids or abrasive substances, not aggressive.

**Liquid temperature range**

- from 0°C to +35°C for domestic use  
(EN 60335-2-41)

- from -10°C to +80°C for other uses.

**Maximum ambient temperature** +40°C

**Maximum working pressure** 10 bar (1000 kPa).

**Installation** fixed in horizontal position.

**IE3 ≥ 0,75 kW**

**IE2 ≥ 0,75 kW**

**EXTRA EU**

MODEL	CODE	ELECTRICAL DATA						HYDRAULIC DATA								DNA	DNM	WEIGHT Kg	Q.TY x PALLET
		VOLTAGE 50 Hz	P1 MAX kW	P2 NOMINAL		In A	MOTOR TYPE	Q=m³h Q=l/min	0	0,3	0,6	0,9	1,2	1,8	2,4				
KP 60/6 M	101110280	1 x 230 V ~	0,54	0,37	0,5	2,4	-	H (m)	87	57	33	13				½" G	½" G	8,2	39
KP 60/6 T	101110290	3 x 230 - 400 V ~	0,52	0,37	0,5	1,8-1	-		87	57	33	13				½" G	½" G	7,9	39
KP 60/12 M	101110320	1 x 230 V ~	1,15	0,75	1	5,2	-		107	91	74	58	43	17		¾" G	¾" G	10,1	39
KP 60/12 T	60180170	3 x 230 - 400 V ~	1,12	0,75	1	3,8-2,2	<b>IE3</b>		107	91	74	58	43	17		¾" G	¾" G	9,90	39
KP 60/12 T	60145184	3 x 230 - 400 V ~	1,12	0,75	1	3,8-2,2	<b>IE2</b>	H (m)	107	91	74	58	43	17		¾" G	¾" G	9,90	39



# KE TWIN IMPELLERS

TWIN IMPELLERS CENTRIFUGAL PUMPS WITH INVERTER MCE/P



Twin impeller centrifugal pump, suitable for pressure booster systems and domestic, civil, industrial and agricultural systems. Particularly versatile thanks to the use of the **MCE/P** inverter, this pump guarantees the automatic adjustment of its performance to the various system requirements, while maintaining constant the differential pressure. Pressure sensor included. Pump body and motor support in cast iron. Technopolymer impeller. Carbon/ceramic mechanical seal. Asynchronous, closed motor cooled by external ventilation. Motor shaft mounted on generously sized ball bearings to ensure silent running and long life.

### Operating range

from 2 to 30 m<sup>3</sup>/h with head up to 95 meters.

### Liquid temperature range

from -10 °C to 50 °C: for KE 35/40, KE 45/50, KE 55/100.

from -15 °C to 110 °C: for KE 55/50, K 66/100, K 90/100, K 70/300, K 80/300, K 70/400, K 80/400.

**Pumped liquid** clean, free from solids or abrasive substances, not viscous, not aggressive, not crystallised and chemically neutral, close to the properties of water. **Installation:** normally horizontal or vertical provided the motor is always above the pump.

**Maximum ambient temperature** +40°C.

### Maximum working pressure

KE 35/40: 6 bar (600 kPa)

KE 45/50, KE 55/50: 8 bar (800 kPa)

KE 55/100, KE 66/100: 10 bar (1000 kPa)

KE 90/100, KE 70/300, KE 80/300 KE 70/400,

KE 80/400: 12 bar (1200 kPa).

**Protection rating** IP 44.

**Terminal box protection rating** IP 55.

**Insulation class** F.



PAG. 5

MCE/P  
PAG. 19

## KE TWIN IMPELLERS WITH MCE/P - FOR PRESSURIZATION SYSTEM

MODEL	CODE	ELECTRICAL DATA				HYDRAULIC DATA																	DNA	DNM	Weight Kg				
		VOLTAGE 50 Hz	P1 MAX kW	P2 NOMINAL		In A	Q=m <sup>3</sup> /h Q=l/min	H																					
				kW	HP			0	1,2	1,8	2,4	3,6	4,8	6	7,2	9	9,6	10,8	12	15	18	24				30			
KE 35/40 M MCE11/P	60147869	1 x 230V	1,3	0,75	1,0	10,3	43,5	41,5	40	38	33	23,5												1" G	1" G	20,5			
KE 45/50 M MCE15/P	60147870	1 x 230V	2	1,6	2,2	14,7	51	49	47,5	46	42	37	30													1¼" G	1" G	27,7	
KE 55/50 M MCE15/P	60147871	1 x 230V	2,53	1,6	2,2	18,1	62	60	58	57	52	45	34														1½" G	1" G	28,2
KE 55/100 T MCE30/P	60144859	3 x 400V	3,66	2,2	3,0	8,93	62			59,5	57	54,5	51	47	39	36											1½" G	1" G	44,9
KE 66/100 T MCE30/P	60144860	3 x 400V	4,32	3,0	4,0	9,64	73			70	67,5	64	60,5	57	49	47											1½" G	1" G	47,5
KE 90/100 T MCE55/P	60144861	3 x 400V	5,23	3,0	4,0	10,8	83,5			82	79,5	76,5	72,5	68	61	58											1½" G	1" G	50,8
KE 70/300 T MCE55/P	60180171	3 x 400V	6,73	5,5	7,5	14,1	76						74	73	72	71,5	70	69	65	60,5	43,5						2" G	1¼" G	79,8
KE 80/300 T MCE110/P	60167383	3 x 400V	9,83	7,5	10,0	19,4	95							93	92,2	91	90,5	90	89,5	87	82	68					2" G	1¼" G	86,6
KE 70/400 T MCE110/P	60167384	3 x 400V	9,57	9,2	12,5	20,4	86								84	83,2	82,5	82	79	76	65	47					2" G	1¼" G	86,9
KE 80/400 T MCE110/P	60167385	3 x 400V	11,2	11,0	15,0	22,7	97										95	94,5	94	92	89	80	64				2" G	1¼" G	90,9

# ENBLOC CENTRIFUGAL PUMPS WITH INVERTER - FOR PRESSURIZATION SYSTEM

PERFORMANCE RANGE

## NKM-GE 4 POLES WITH MCE/P

> 1450 1/min

MODEL	P2 NOMINAL		Q (m³/h) (l/min)	H (m)																																			
	kW	HP		0	6	12	18	24	30	36	42	48	54	60	66	72	78	84	90	102	114	120	150	180	210	240	270	300	330	360									
				0	100	200	300	400	500	600	700	800	900	1000	1100	1200	1300	1400	1500	1700	1900	2000	2500	3000	3500	4000	4500	5000	5500	6000									
NKM-GE40-250/260/A/BAQE/ 3 /4 MCE30/P	3	4	23.3	23.1	22.8	22.2	20.8	19																															
NKM-GE50-250/263/A/BAQE/ 4/4 MCE30/P	4	5.5	23.8		23.8	23.8	23.4	22.7	21.6	20.4	19	17.1																											
NKM-GE65-250/263/A/BAQE/ 5,5 /4MCE55/P	5.5	7.5	24.1				23.8	23.6	23.3	22.8	22.3	21.5	20.8	19.7	18.6	17.3																							
NKM-GE65-315/309/A/BAQE/11/4 MCE110/P	11	15	34.2							33.2	33	32.5	32	31.5	30.7	29.8	29	28	25	21.7																			
NKM-GE80-250/270/A/BAQE/11/4 MCE110/P	11	15	25.6							25.5	25.5	25.4	25.1	25	24.8	24.6	24.2	24	23	21.5	21																		
NKM-GE80-315/305/A/BAQE/15/4 MCE150/P	15	20	32.9									32.7	32.6	32.6	32.5	32.4	32	31.6	30.5	29.5	28.9	24																	
NKM-GE100-250/250/A/BAQE/11/4 MCE110/P	11	15	21.1										21	21	21	21	21	21	21	20.9	20	19.8	18	16															
NKM-GE100-250/270/A/BAQE/15/4MCE150/P	15	20	25.5										25.5	25.5	25.5	25.3	25.1	25.1	25	24.5	24	22.5	20.5	17.5															
NKM-GE125-250/243/A/BAQE/15 /4 MCE150/P	15	20	19.5																		19.3	19.3	19.2	19.2	18.7	17.8	16.8	15.5	14.1	12.5	10.9								

## NKP-GE 2 POLES WITH MCE/P

> 2900 1/min

MODEL	P2 NOMINAL		Q (m³/h) (l/min)	H (m)																							
	kW	HP		0	6	12	18	24	30	36	42	48	54	60	66	72	78	84	90	102	114	120	150	180	210		
				0	100	200	300	400	500	600	700	800	900	1000	1100	1200	1300	1400	1500	1700	1900	2000	2500	3000	3500		
NKP-GE32-125.1/125/A/BAQE /1.5/2 MCE11/P	1.5	2	21	20.8	19	16.8																					
NKP-GE 32-125.1/140/A/BAQE/2.2/2 MCE15/P	2.2	3	27	26.9	25.9	23	19.5																				
NKP-GE 32-125/130/A/BAQE / 2.2 /2 MCE15/P	2.2	3	23.6	23.1	23	21.6	19.6	16.8																			
NKP-GE 32-125/142/A/BAQE / 3 /2 MCE30/P	3	4	28.6	28	27.6	26.5	24.6	21.8	17.9																		
NKP-GE 32-160.1 166/A/BAQE /3/2 MCE30/P	3	4	35.3	35	33	28																					
NKP-GE 32-160/151/A/BAQE/3/2 MCE30/P	3	4	30.5	30	29	27	24	19.5																			
NKP-GE 32-160/177/A/BAQE /5,5/2MCE55/P	5.5	7.5	43.5	43.2	42.6	41.5	39	36	31.5	25.5																	
NKP-GE32-200.1 205/A/BAQE/5,5/2 MCE55/P	5.5	7.5	56.6	55.7	52	45.8	36.2																				
NKP-GE 32-200/190/A/BAQE/5,5 /2MCE55/P	5.5	7.5	46.9	46.5	45	43	40	35	29																		
NKP-GE 32-200/210/A/BAQE/7.5 /2MCE110/P	7.5	10	58.8	58	57	56	53	49	44																		
NKP-GE 40-125/120/A/BAQE/2.2/2MCE22/P	2.2	3	19	18.7	18.4	17.8	17	15.9	14.6	13	11																
NKP-GE 40-125/130/A/BAQE/3/2 MCE30/P	3	4	22.8	22.5	22.3	22	21.2	20.2	19	17.4	15.5	13.5															
NKP-GE 40-125/139/A/BAQE/4/2 MCE55/P	4	5.5	26.4	26.2	26	25.6	25	24	23	21.5	19.5	17.5	15														
NKP-GE 40-160/158/A/BAQE/5,5/2MCE55/P	5.5	7.5	33.7			34	33.4	32.4	31	29.5	27	24															
NKP-GE40-160/172/A/BAQE/7,5/2MCE110/P	7.5	10	40.7			40.2	40.1	39.8	38.5	37.5	35.5	33	30	26.5													
NKP-GE 40-200/210/A/BAQE/11/2 MCE110/P	11	15	57.1	57	57	56.8	56.5	56	55	53	50	47	43.5	39													
NKP-GE40-250/230/A/BAQE/15/2 MCE150/P	15	20	72.5			72.5	72	70	68	66	62.5	60	56	51.5													
NKP-GE50-125/135/A/BAQE/5,5 /2 MCE55/P	5.5	7.5	24				23.6	23.5	23.2	22.8	22.2	21.5	21	20	19.1	18.5	17.5	16.5	13.4								
NKP-GE50-125/144/A/BAQE/7,5/2MCE55/P	7.5	10	28				27.8	27.5	27.3	27	26.5	25.8	25.3	24.5	23.5	23	21.5	20.5	18	15.5							
NKP-GE50-160/169/A/BAQE/11/2 MCE110/P	11	15	39.6					39.5	39.3	39.1	39	38.5	38	37.2	36.5	35	34	32.5									
NKP-GE 50-200/200/A/BAQE /15/2 MCE150/P	15	20	55.1					54.7	54.6	54	53.5	52	51	49	47.5	45.5	43	41									
NKP-GE 65-125/127/A/BAQE/5,5/2MCE55/P	5.5	7.5	19.5						19	18.9	18.7	18.4	18.1	17.5	17.2	16.9	16.5	15.8	14.5	13	12						
NKP-GE65-125/137/A/BAQE/7,5/2MCE110/P	7.5	10	23.5						23.1	23	22.8	22.6	22.5	22	21.6	21.1	20.7	20.2	19	17.5	14.8	12					
NKP-GE65-160/157/A/BAQE/11/2MCE110/P	11	15	32.5								32.3	32	31.9	31.3	30.2	30	29.2	28.7	27	24.8	23.6						
NKP-GE65-160/173/A/BAQE/15/2MCE150/P	15	20	40.1								39.7	39.6	39.5	39.5	39	38.5	38.2	37.5	36	34.5	33.5	26.9					
NKP-GE80-160/147-127/A/BAQE/11/2MCE110/P	11	15	24															22	21.4	20.4	20	17.4	16.8	12			
NKP-GE 80-160/153/A/BAQE/15/2 MCE150/P	15	20	30.5															29	28.4	27.5	27	24.5	21.3	18.3			

CENTRIFUGAL PUMPS

# NKM-GE / NKP-GE WITH MCE/P

ENBLOC CENTRIFUGAL PUMPS WITH INVERTER



Enbloc electric centrifugal pumps with coupling, designed for a wide range of applications such as:

- homes;
- apartment blocks;
- camp sites;
- swimming pools;
- farms;
- well water supply;
- irrigation for greenhouses, gardens, agriculture;
- re-use of rainwater;
- industrial systems.



Highly versatile pumps thanks to the use of the **MCE/P** inverter, to guarantee performance able to automatically adapt to the various system requirements, while maintaining constant pressure. Spiral single-stage body in cast iron according to DIN-EN 733 (ex DIN 24255), cast iron support, flanges according to DIN 2533 and DIN 2532 for DN 200. Cast iron impeller, sealed and dynamically balanced with compensation of the axial thrust via balancing holes, operating (on request) on interchangeable wear rings. Pump shaft in AISI 304 stainless steel. Seal: standardised mechanical seal according to DIN 24960 in carbon/silicon carbide with O-rings in EPDM. Asynchronous, closed motor cooled by external ventilation, construction design B3/B5, 2-pole for NKPGE and 4-pole for NKM-GE.

Rotor mounted on generously sized ball bearings to ensure silent and durable operation.

**Speed of rotation** 1450 - 2900 1/min.

### Operating range

from 1 a 450 m<sup>3</sup>/h head up to 72 metri.

**Liquid temp. range** from -10°C to +80°C.

**Pumped liquid** clean, free from solids or abrasive substances, not viscous, not aggressive, not crystallised and chemically neutral and close to the characteristics of water. **Installation:** normally horizontal or vertical provided the motor is always above the pump.

**Max. ambient temperature** +40°C

### Maximum operating pressure

16 bar - 1600 kPa (for DN 200 max. 10 bar).

**Protection rating** IP 55

**Insulation class** F

**Flanging** PN 16 DIN 2533

### Special versions on request

Pumps for liquids other than water.

Other voltages and/or frequencies.

Inverter modulation with 0-10V signal

IE3 ≥ 0,75 kW



PAG. 5

MCE/P  
PAG. 19

ACCESSORIES  
PAG. 205

## NKM-GE 4 POLES WITH MCE/P - FOR PRESSURIZATION SYSTEM

MODEL	CODE	ELECTRICAL DATA				MODEL MCE	DNA	DNM	WEIGHT Kg
		VOLTAGE 50 Hz	P2 NOMINAL		In A				
			KW	HP					
NKM-GE 40-250/245/A/BAQE/ 2,2 /4 MCE30/P	60192059	3x400 V	2,2	3,0	6,6	MCE30/P	65	40	89
NKM-GE40-250/260/A/BAQE/ 3 /4 MCE30/P	60192060	3x400 V	3,0	4,0	7,9	MCE30/P	65	40	98
NKM-GE50-250/263/A/BAQE/ 4/4 MCE30/P	60192061	3x400 V	4,0	5,5	10,0	MCE30/P	65	50	105
NKM-GE65-250/263/A/BAQE/ 5,5 /4MCE55/P	60192062	3x400 V	5,5	7,5	13,4	MCE55/P	80	65	168
NKM-GE65-315/279/A/BAQE/ 7,5 /4MCE110/P	60167386	3x400 V	7,5	10,0	17,9	MCE110/P	80	65	195
NKM-GE65-315/309/A/BAQE/11/4 MCE110/P	60167387	3x400 V	11,0	15,0	27,2	MCE110/P	80	65	263
NKM-GE80-250/240/A/BAQE/7,5/4MCE110/P	60167388	3x400 V	7,5	10,0	17,9	MCE110/P	100	80	185
NKM-GE80-250/270/A/BAQE/11/4 MCE110/P	60167389	3x400 V	11,0	15,0	27,2	MCE110/P	100	80	237
NKM-GE80-315/305/A/BAQE/15/4 MCE150/P	60167390	3x400 V	15,0	20,0	36,5	MCE150/P	100	80	294
NKM-GE100-250/250/A/BAQE/11/4 MCE110/P	60167391	3x400 V	11,0	15,0	27,2	MCE110/P	125	100	245
NKM-GE100-250/270/A/BAQE/15/4MCE150/P	60167392	3x400 V	15,0	20,0	36,5	MCE150/P	125	100	268
NKM-GE125-250/243/A/BAQE/15 /4 MCE150/P	60167393	3x400 V	15,0	20,0	36,5	MCE150/P	150	125	305

## KI

## AISI 304 STAINLESS STEEL SINGLE IMPELLER CENTRIFUGAL PUMPS



## NEW MODELS



Axial suction AISI 304 stainless steel single impeller centrifugal pump for pressurization in civil and industrial environments (cold and hot liquids, and coolants), of thermal waters, and for industrial washing systems.

The standard construction materials ensure higher resistance to oxidation (rust) and therefore to erosion, and most of all operation at high temperatures (90°C).

Other possibilities of use are: in propylene glycol (V version) and ethylene glycol (E version) chiller systems; in industrial washing systems using cold water, hot water, and coolants; with moderately oily or aggressive liquids (V and VS version)

**Operating range**

up to 10 m<sup>3</sup>/h with head up to 32 metres.

**Pumped liquid** clean, free of solids and abrasives, non-viscous, non-crystallised and chemically neutral, with properties similar to water.

**Liquid temperature range** from -10 °C to +90 °C

**Maximum ambient temperature** +40 °C

**Maximum operating pressure** 8 bar (800 kPa)

**Protection class** IP 55

**Insulation class** F

**Standard voltage** 220-230 V/50 Hz single-phase, 230-400 V/50 Hz three-phase

**Installation** fixed horizontal or vertical position, provided that the motor is always above the pump.

**Special executions on request**

special mechanical seals:

**V version** Alox Ceramic/Carbon/FKM: for oily liquids (up to 110°C) and propylene glycol.

**VS version** SiC/SiC/FKM: for oily liquids (up to 110°C) and abrasive particles.

**Version E** SiC/Carbon/EPDM: water up to 120°C and ethylene glycol.

IE3 ≥ 0,75 kW

IE2 ≥ 0,75 kW

EXTRA EU

## KI

MODEL	CODE	ELECTRICAL DATA						HYDRAULIC DATA														DNA	DNM	KG	Q.TY x PALLET		
		VOLTAGE 50 Hz	P1 MAX kW	P2 NOMINAL		In A	MOTOR TYPE	Q=m <sup>3</sup> /h		H																	
				kW	HP			Q=	l/min	0	1,2	3	4,8	5,4	6,6	7,8	8,4	9,6	10,8	11,7	195						
KI 30/90 M	60173605	1x220-230 V	1,4	0,75	1	6,5	-	H (m)	31,4	30,1	27,8	25,1	24,0	21,7	19,0	17,5					1"1/4 G	1" G	13,4	27			
KI 30/90 T	60184269	3x230/400 V	1,25	0,75	1	4 / 2,3	IE3		31,4	30,1	27,8	25,1	24,0	21,7	19,0	17,5					1"1/4 G	1" G	12,2	27			
KI 30/120 M	60173606	1x220-230 V	1,55	1	1,36	7	-		32,0	30,7	28,9	27,0	26,3	24,8	22,8	21,6	19,2	16,5			1"1/4 G	1" G	13,4	27			
KI 30/120 T	60179404	3x230/400 V	1,4	1	1,36	4,7 / 2,7	IE3		32,0	30,7	28,9	27,0	26,3	24,8	22,8	21,6	19,2	16,5			1"1/4 G	1" G	12,3	27			
KI 40/120 M*	60173608	1x220-230 V	2,2	1,5	2	9,7	-		40,3	39,1	37,2	35,2	34,5	33,0	31,3	30,4	28,5	26,4	23,0			1"1/4 G	1" G	19,6	18		
KI 40/120 T*	60184272	3x230/400 V	2,1	1,5	2	7 / 4,1	IE3		40,3	39,1	37,2	35,2	34,5	33,0	31,3	30,4	28,5	26,4	23,0			1"1/4 G	1" G	19,3	27		
KI 30/90 T	60184268	3x230/400 V	1,29	0,75	1	4,5 / 2,6	IE2	H (m)	31,4	30,1	27,8	25,1	24,0	21,7	19,0	17,5					1"1/4 G	1" G	12,2	27			
KI 30/120 T	60173607	3x230/400 V	1,45	1	1,36	5 / 2,9			32,0	30,7	28,9	27,0	26,3	24,8	22,8	21,6	19,2	16,5			1"1/4 G	1" G	13,8	27			
KI 40/120 T*	60184271	3x230/400 V	2,2	1,5	2	7,5 / 4,3			40,3	39,1	37,2	35,2	34,5	33,0	31,3	30,4	28,5	26,4	23,0			1"1/4 G	1" G	19,3	27		

\* Not MEI comply, only for EXTRA EU Market

## PRICE LIST INCREASE FOR SPECIAL SEALS

E.g.: KI 30/90 M with elastomers and FKM seal: KI 30/90 M -V

ADDITIONAL DESCRIPTION	MECHANICAL SEAL MATERIAL	ELASTOMERS
-V	Carbon/Alox Ceramic/FKM	FKM
-VS	SiC/SiC/FKM	FKM
-E	Carbon/SiC/EPDM	EPDM

# K SINGLE IMPELLER

## SINGLE IMPELLER CENTRIFUGAL PUMPS



### NEW MODELS



K 35/1200 T

Single impeller centrifugal pump suitable for domestic, civil, industrial and agricultural installations and for decanting, mixing and irrigating uses. Cast iron pump body and motor support. Technopolymer impeller. Stainless steel driving shaft. Carbon/ceramic mechanical seal. Asynchronous, closed motor, cooled by external ventilation. Built-in thermal and current overload protection and a capacitor permanently on in the single-phase version. For the protection of the three-phase motor it is advisable to use a suitable overload protection complying with the regulations in force.

**Operating range** from 1,8 to 96 m<sup>3</sup>/h with head up to 62 metres.

**Pumped liquid characteristics** clean, free from solids or abrasive substances, not viscous, not aggressive, not crystallised, chemically neutral and close to the characteristics of water.

#### Liquid temperature range

from -10°C to +50°C: for K 20/41, K 30/70, K 30/100, K 36/100, K 12/200, K 36/200, K 40/200.

from -15°C to +110°C: for the other pups.

#### Maximum operating range

K 20/41, K 30/70, K 30/100, K 36/100, K 12/200, K 14/400: **6 bar (600 kPa)**  
 K 36/200, K 40/200, K 55/200, K 11/500, K 18/500, K 28/500: **8 bar (800 kPa)**  
 K 40/400, K 50/400, K 30/800, K 40/800, K 50/800,  
 K 20/1200, K 25/1200, K 35/1200: **10 bar (1000 kPa)**

**Maximum ambient temperature** +40°C.

**Protection level** IP 44.

**Terminal board protection level** IP 55.

**Insulation class** F.

IE3 ≥ 0,75 kW

IE2 ≥ 0,75 kW

EXTRA EU

## K - SINGLE IMPELLER CENTRIFUGAL

MODEL	CODE	ELECTRICAL DATA						HYDRAULIC DATA																Q.TY x PALLET				
		VOLTAGE 50 Hz	P1 MAX kW	P2 NOMINAL		In A	MOTOR TYPE	Q=m <sup>3</sup> /h		Q=l/min		H (m)																
				kW	HP			0	1,8	2,4	3,6	4,8	6	7,2	9	9,6	10,8	12	15	18	DNA	DNM	KG					
K 20/41 M	102110004	1 x 220 - 240 V ~	0,65	0,37	0,5	3	-				20,3	19,4	16,9	13,6	8,3										1" G	1" G	10	39
K 20/41 T	102110014	3 x 230 - 400 V ~	0,64	0,37	0,5	2,3/1,3	-				20,3	19,4	16,9	13,6	8,3										1" G	1" G	9,3	39
K 30/70 M	102110024	1 x 220 - 240 V ~	1,3	0,75	1	6	-	31,8	29,5	28,9	27	24,2	19,8	13,5											1" G	1" G	13,9	30
K 30/70 T	60179407	3 x 230 - 400 V ~	1,2	0,75	1	4,3/2,5	IE3	31,8	29,5	28,9	27	24,2	19,8	13,5											1" G	1" G	13,7	30
K 30/100 M	102110042	1 x 220 - 240 V ~	1,6	1,1	1,5	7,1	-	29,2		29	28,8	28	26,8	25,3	22,5	21,5	18,5								1½" G	1" G	18,5	21
K 30/100 T	60179858	3 x 230 - 400 V ~	1,63	1,1	1,5	6,9/3,9	IE3	29,2		29	28,8	28	26,8	25,3	22,5	21,5	18,5								1½" G	1" G	18,2	21
K 36/100 M	102110162	1 x 220 - 240 V ~	2,1	1,85	2,5	8,8	-	34,9		34,8	34,6	34	33	32	29,8	29	26,5								1½" G	1" G	23,3	18
K 36/100 T	60179861	3 x 230 - 400 V ~	2	1,85	2,5	6,9/4	IE3	34,9		34,8	34,6	34	33	32	29,8	29	26,5								1½" G	1" G	19,7	21
K 12/200 M	60168883	1 x 220 - 240 V ~	1,24	0,75	1	5,8	-	18,4		17,2	16,5	16	15,3	14,7	13,5	13,1	12,3	11,4	8,9	5,5	1½" G	1½" G			1½" G	1½" G	13,7	30
K 12/200 T	60179406	3 x 230 - 400 V ~	1,15	0,75	1	3,6/2,1	IE3	18,4		17,2	16,5	16	15,3	14,7	13,5	13,1	12,3	11,4	8,9	5,5	1½" G	1½" G			1½" G	1½" G	13,8	30
K 36/200 M	60152451	1 x 230	3	2,2	3	13,5	-	36	35,5	35	34	33,3	32,5	31,5	28	23,5									2" G	1¼" G	33,1	18
K 36/200 T	60179375	3 x 230 - 400 V ~	3	2,2	3	9/5,2	IE3	36,6				36	35,5	35	34	33,3	32,5	31,5	28	23,5	2" G	1¼" G			2" G	1¼" G	21	18
K 40/200 M	60152452	1 x 230	3,6	3	4	16	-	41,3				41	40,5	40	39	38,8	38	37	33,5	29	2" G	1¼" G			2" G	1¼" G	34,9	18
K 40/200 T	60179374	3 x 230 - 400 V ~	3,5	3	4	11,1/6,4	IE3	41,3				41	40,5	40	39	38,8	38	37	33,5	29	2" G	1¼" G			2" G	1¼" G	19	18
K 55/200 M	60152453	1 x 230	5	4	5,5	21,8	-	54				54	53,9	53,2	53	52	51,5	48,5	45		2" G	1¼" G			2" G	1¼" G	39	18
K 55/200 T	60179853	3 x 230 - 400 V ~	5	3,7	5	16,3/9,4	IE3	54				54	53,9	53,2	53	52	51,5	48,5	45		2" G	1¼" G			2" G	1¼" G	39	18

# K SINGLE IMPELLER

SINGLE IMPELLER CENTRIFUGAL PUMPS



IE3 ≥ 0,75 kW

IE2 ≥ 0,75 kW

EXTRA EU

MODEL	CODE	ELECTRICAL DATA						HYDRAULIC DATA														DNA	DNM	KG	Q.TY x PALLET		
		VOLTAGE 50 Hz	P1 MAX kW	P2 NOMINAL		In A	MOTOR TYPE	Q=m³/h	0	12	15	18	24	30	36	42	60	72	84	96							
				kW	HP			Q=l/min	0	200	250	300	400	500	600	700	1000	1200	1400	1600							
K 14/400 M	102130402	1 x 220 - 240 V ~	2,1	1,85	2,5	9,5	-	H (m)	19	18,8	18,5	18	16,3	13,8	10							2" G	2" G	24,5	18		
K 14/400 T	60179855	3 x 230 - 400 V ~	2,1	1,85	2,5	7,4	IE3		19	18,8	18,5	18	16,3	13,8	10								2" G	2" G	22	21	
K 11/500 M	60168869	1 x 230	2,5	2,2	3	11,2	-		24,5	22,5	21,5	20	16,5	11,5	6,5								2½" G	2" G	34,2	18	
K 11/500 T	60179379	3 x 230 - 400 V ~	2,6	2,2	3	7,6/4,4	IE3		24,5	22,5	21,5	20	16,5	11,5	6,5								2½" G	2" G	21	18	
K 18/500 M	60168870	1 x 230	3,9	3	4	18	-		29,6	29,2	28,5	27,4	24	19,5	13,8											18	
K 18/500 T	60179380	3 x 230 - 400 V ~	3,4	3	4	10,2/5,9	IE3		29,6	29,2	28,5	27,4	24	19,5	13,8								2½" G	2" G	19	18	
K 28/500 M	60168871	1 x 230	4,7	4	5,5	21,4	-		35	34,5	34	32,8	29,3	25,2	20								2½" G	2" G	42	18	
K 28/500 T	60179882	3 x 230 - 400 V ~	5	3,7	5	14,7/8,5	IE3		35	34,5	34	32,8	29,3	25,2	20								2½" G	2" G	40,6	18	
K 40/400 T	60180172	3 x 400 V ~ <sup>1</sup>	7	5,5	7,5	11,5			50,5	49	48	45	37	24										65	50	79	6
K 50/400 T	60167622	3 x 400 V ~ <sup>1</sup>	9	7,5	10	14,5			62	61	60	59	54,5	46										65	50	78,8	6
K 30/800 T	60167623	3 x 400 V ~ <sup>1</sup>	7,6	7,5	10	13,4			44				42	40	38	35	21,5							80	65	90,2	6
K 40/800 T	60167624	3 x 400 V ~ <sup>1</sup>	10,2	9,2	12,5	17,1			51,5				50	48	47	43,5	32,5	21						80	65	95	6
K 50/800 T	60167625	3 x 400 V ~ <sup>1</sup>	11,6	11	15	20			58				56,5	55	53,5	51	41	31						80	65	104,3	6
K 20/1200 T	60167626	3 x 400 V ~ <sup>1</sup>	8,3	7,5	10	15			37,5				36,5	36	35	34	30	26	21	15				80	65	88	6
K 25/1200 T	60167627	3 x 400 V ~ <sup>1</sup>	9,1	9,2	12,5	17,3			40,7				39	38,5	38	37	33,5	30	25	18				80	65	94	6
K 35/1200 T	60167628	3 x 400 V ~ <sup>1</sup>	10,6	11	15	18,4			45						43	42,5	38,5	35	31,5	27				80	65	100	6

MODEL	CODE	ELECTRICAL DATA						HYDRAULIC DATA														DNA	DNM	KG	Q.TY x PALLET		
		VOLTAGE 50 Hz	P1 MAX kW	P2 NOMINAL		In A	MOTOR TYPE	Q=m³/h	0	1,8	2,4	3,6	4,8	6	7,2	9	9,6	10,8	12	15	18						
				kW	HP			Q=l/min	0	30	40	60	80	100	120	150	160	180	200	250	300						
K 30/70 T	60145269	3 x 230 - 1 400 V ~	1,2	0,75	1	4,3/2,5	IE2	H (m)	31,8	29,5	28,9	27	24,2	19,8	13,5								1" G	1" G	13,7	30	
K 30/100 T	60145771	3 x 230 - 400 V ~	1,63	1,1	1,5	6,9/3,9			29,2		29	28,8	28	26,8	25,3	22,5	21,5	18,5						1½" G	1" G	18,2	21
K 36/100 T	60145837	3 x 230 - 400 V ~	2	1,85	2,5	6,9/4			34,9		34,8	34,6	34	33	32	29,8	29	26,5						1½" G	1" G	19,7	21
K 12/200 T	60168884	3 x 230 - 400 V ~	1,15	0,75	1	3,6/2,1			18,4		17,2	16,5	16	15,3	14,7	13,5	13,1	12,3	11,4	8,9	5,5			1½" G	1½" G	13,8	30
K 36/200 T	60146040	3 x 230 - 400 V ~	3	2,2	3	9,5/2			36,6				36	35,5	35	34	33,3	32,5	31,5	28	23,5			2" G	1¼" G	33,1	18
K 40/200 T	60146050	3 x 230 - 400 V ~	3,5	3	4	11,1/6,4			41,3				41	40,5	40	39	38,8	38	37	33,5	29			2" G	1¼" G	34,9	18
K 55/200 T	60146064	3 x 230 - 400 V ~	5,1	4	5,5	16,3/9,4			54					54	53,9	53,2	53	52	51,5	48,5	45			2" G	1¼" G	39	18

MODEL	CODE	ELECTRICAL DATA						HYDRAULIC DATA														DNA	DNM	KG	Q.TY x PALLET	
		VOLTAGE 50 Hz	P1 MAX kW	P2 NOMINAL		In A	MOTOR TYPE	Q=m³/h	0	12	15	18	24	30	36											
				kW	HP			Q=l/min	0	200	250	300	400	500	600											
K 14/400 T	60145845	3 x 230 - 400 V ~	2,1	1,85	2,5	7,4	IE2	H (m)	19	18,8	18,5	18	16,3	13,8	10							2" G	2" G	22	21	
K 11/500 T	60168866	3 x 230 - 400 V ~	2,6	2,2	3	7,6/4,4			24,5	22,5	21,5	20	16,5	11,5	6,5								2½" G	2" G	34,2	18
K 18/500 T	60168867	3 x 230 - 400 V ~	3,4	3	4	10,2/5,9			29,6	29,2	28,5	27,4	24	19,5	13,8								2½" G	2" G	36,6	18
K 28/500 T	60168868	3 x 230 - 400 V ~	4,5	4	5,5	14,7/8,5			35	34,5	34	32,8	29,3	25,2	20								2½" G	2" G	40,6	18

<sup>1</sup> Star (A) starting is possible

## K - SINGLE IMPELLER CENTRIFUGAL - SINGLE-PHASE

MODEL	CODE	ELECTRICAL DATA						HYDRAULIC DATA														DNA	DNM	WEIGHT Kg	Q.TY x PALLET		
		VOLTAGE 50 Hz	P1 MAX kW	P2 NOMINAL		In A	MOTOR TYPE	Q=m³/h	0	4,8	6	7,2	9	9,6	10,8	12	15	18	24	30	36						
				kW	HP			Q=l/min	0	80	100	120	150	160	180	200	250	300	400	500	600						
K 36/200 M	60152451	1 x 230	3,0	2,2	3	13,5	IE2	H (m)	36,6	36	35,5	35	34	33,3	32,5	31,5	28	23,5					2" G	1¼" G	33,1	18	
K 40/200 M	60152452	1 x 230	3,6	3	4	16,0			41,3	41	40,5	40	39	38,8	38	37	33,5	29						2" G	1¼" G	34,9	18
K 55/200 M	60152453	1 x 230	5,0	4	5,5	21,8			54		54	53,9	53,2	53	52	51,5	48,5	45						2" G	1¼" G	39	18
K 11/500 M	60168869	1 x 230	2,5	2,2	3	11,2			24,5							22,5	21,5	20	16,5	11,5	6,5			2½" G	2" G	34,2	18

# K TWIN IMPELLERS

TWIN IMPELLERS CENTRIFUGAL PUMPS



## NEW MODELS



K 35/40 M



K 70/300 T

Twin impeller centrifugal pump designed for use in pressurisation units for water supply systems for domestic, civil and industrial use. Suitable for sprinkling irrigation and other water supply applications. Cast iron pump body and motor support. Technopolymer impeller. Stainless steel driving shaft. Carbon/ceramic mechanical seal. Asynchronous, closed motor, cooled by external ventilation. Built-in thermal and current overload protection and a capacitor permanently on in the single-phase version. For the protection of the three-phase motor it is advisable to use a suitable overload protection complying with the regulations in force.

### Operating range

from 1.2 to 30 m<sup>3</sup>/h with head up to 97 metres.

**Pumped liquid characteristics** clean, free from solids or abrasive substances, not viscous, not aggressive, not crystallised, chemically neutral and close to the characteristics of water.

### Liquid temperature range

from -10°C to +50°C: for K 35/40, K 45/50, K 35/100, K 40/100, K 55/100  
from -15°C to +110°C: for K 55/50, K 66/100, K 90/100, K 70/300, K 80/300, K 70/400, K 80/400.

### Maximum operating range

K 35/40, K 35/100, K 40/100: **6 bar (600 kPa)**

K 45/50, K 55/50: **8 bar (800 kPa)**

K 55/100, K 66/100: **10 bar (1000 kPa)**

K 90/100, K 70/300, K 80/300 K 70/400,

K 80/400: **12 bar (1200 kPa).**

**Maximum ambient temperature** +40°C

**Protection level** IP 44

**Terminal board protection level** IP 55

**Insulation class** F

IE3 ≥ 0,75 kW

IE2 ≥ 0,75 kW

EXTRA EU

## K - TWIN IMPELLERS CENTRIFUGAL

MODEL	CODE	ELECTRICAL DATA					HYDRAULIC DATA																			DNA	DNM	KG	Q.TY x PALLET
		VOLTAGE 50 Hz	P1 MAX kW	P2 NOMIN. kW HP	In A	MOTOR TYPE	Q=m <sup>3</sup> /h	0	1,2	1,8	2,4	3,6	4,8	6	7,2	9	9,6	10,8	12	15	18	24	30						
K 35/40 M	102120004	1 x 220 - 240 V ~	1,2	0,75	1	5,5	-	43,5	41,5	40	38	33	23,5											1" G	1" G	15,9	27		
K 35/40 M-P**	102122004	1 x 220 - 240 V ~	1,2	0,75	1	5,5	-	43,5	41,5	40	38	33	23,5											1" G	1" G	16,7	14		
K 35/40 T	60179870	3 x 230 - 400 V ~	1,2	0,75	1	3,8-2,2	IE3	43,5	41,5	40	38	33	23,5											1" G	1" G	15	27		
K 45/50 M	102120022	1 x 220 - 240 V ~	1,86	1,1	1,5	8,3	-	51	49	47,5	46	42	37	30										1 1/4" G	1" G	23,3	21		
K 45/50 M-P**	102122022	1 x 220 - 240 V ~	1,86	1,1	1,5	8,3	-	51	49	47,5	46	42	37	30										1 1/4" G	1" G	24	21		
K 45/50 T	60179854	3 x 230 - 400 V ~	1,96	1,1	1,5	5,9-3,4	IE3	51	49	47,5	46	42	37	30										1 1/4" G	1" G	22,5	21		
K 55/50 M	102120162	1 x 220 - 240 V ~	2,7	1,85	2,5	12,8	-	62	60	58	57	52	45	34										1 1/2" G	1" G	27,2	18		
K 55/50 T	60179852	3 x 230 - 400 V ~	2,5	1,85	2,5	8,4-4,8	IE3	62	60	58	57	52	45	34										1 1/2" G	1" G	23,9	21		
K 35/100 M	102121002	1 x 220 - 240 V ~	1,56	1,1	1,5	7,1	-	38,5				37,5	36,5	35	32	28,5	18,5	17,5							1 1/2" G	1" G	22	21	
K 35/100 T	60179877	3 x 230 - 400 V ~	1,65	1,1	1,5	6,5-3,5	IE3	38,5				37,5	36,5	35	32	28,5	18,5	17,5							1 1/2" G	1" G	21	21	
K 40/100 M	102121032	1 x 220 - 240 V ~	2	1,85	2,5	9	-	44				43,4	42,5	41	39	35,7	29	26	18,5						1 1/2" G	1" G	25,9	18	
K 40/100 T	60179869	3 x 230 - 400 V ~	2	1,85	2,5	7-4	IE3	44				43,4	42,5	41	39	35,7	29	26	18,5						1 1/2" G	1" G	22	21	
K 55/100 M	60152448	1 x 230	3,4	2,2	3	14,9	-	62				59,5	57	54,5	51	47	39	36							1 1/2" G	1" G	40	18	
K 55/100 T	60179373	3 x 230 - 400 V ~	3,9	2,2	3	11,6-6,7	IE3	62				59,5	57	54,5	51	47	39	36							1 1/2" G	1" G	19	18	
K 66/100 M	60152449	1 x 230	4,4	3	4	19,5	-	73				70	67,5	64	60,5	57	49	47							1 1/2" G	1" G	44	18	
K 66/100 T	60179857	3 x 230 - 400 V ~	5	3,7	5	14,6-8,4	IE3	73				70	67,5	64	60,5	57	49	47							1 1/2" G	1" G	40,7	18	
K 90/100 M	60152450	1 x 230	5	4	5,5	21,9	-	83,5				82	79,5	76,5	72,5	68	61	58							1 1/2" G	1" G	46	18	
K 90/100 T	60179859	3 x 230 - 400 V ~	5	3,7	5	16,5-9,5	IE3	83,5				82	79,5	76,5	72,5	68	61	58							1 1/2" G	1" G	44	18	
K 70/300 T	60179381	3 x 400 V ~ <sup>1</sup>	7,1	5,5	7,5	12,9	-	76							74	73	72	71,5	70	69	65	60,5	43,5	2" G	1 1/4" G	72	6		
K 80/300 T	60167629	3 x 400 V ~ <sup>1</sup>	9,10	7,5	10	15,20	IE3	95							93	92,2	91	90,5	90	89,5	87	82	68	2" G	1 1/4" G	78,5	6		
K 70/400 T	60167630	3 x 400 V ~ <sup>1</sup>	9,20	9,2	12,5	15,50	-	86								84	83,2	82,5	82	79	76	65	47	2" G	1 1/4" G	74	6		
K 80/400 T	60167631	3 x 400 V ~ <sup>1</sup>	12,5	11	15	21	-	97									95	94,5	94	92	89	80	64	2" G	1 1/4" G	79	6		

<sup>1</sup> Star (Λ) starting is possible

\*\* Pump equipped with pressure gauge, pressure switch, power cable with plug and five - way fitting to use for connecting to a tank.

# K TWIN IMPELLERS

TWIN IMPELLERS CENTRIFUGAL PUMPS



IE3 ≥ 0,75 kW

IE2 ≥ 0,75 kW

EXTRA EU

## K - TWIN IMPELLERS CENTRIFUGAL

MODEL	CODE	ELECTRICAL DATA						HYDRAULIC DATA													DNA	DNM	KG	Q.TY x PALLET				
		VOLTAGE 50 Hz	P1 MAX kW	P2 NOMINAL		In A	MOTOR TYPE	Q=m³/h																				
				kW	HP			0	1,2	1,8	2,4	3,6	4,8	6	7,2	9	9,6	10,8	0	20					30	40	60	80
K 35/40 T	60145196	3 x 230 - 400 V ~	1,2	0,75	1	3,8-2,2	IE2	H (m)	43,5	41,5	40	38	33	23,5										1" G	1" G	15	27	
K 45/50 T	60145774	3 x 230 - 400 V ~	1,96	1,1	1,5	7,2-4			51	49	47,5	46	42	37	30										1½" G	1" G	22,5	21
K 55/50 T	60145840	3 x 230 - 400 V ~	2,5	1,85	2,5	8,4-4,8			62	60	58	57	52	45	34										1½" G	1" G	23,9	21
K 35/100 T	60145775	3 x 230 - 400 V ~	1,65	1,1	1,5	6,5-3,5			38,5				37,5	36,5	35	32	28,5	18,5	17,5						1½" G	1" G	21	21
K 40/100 T	60145841	3 x 230 - 400 V ~	2	1,85	2,5	7-4			44				43,4	42,5	41	39	35,7	29	26	18,5					1½" G	1" G	22	21
K 55/100 T	60146054	3 x 230 - 400 V ~	3,9	2,2	3	11,6-6,7			62				59,5	57	54,5	51	47	39	36						1½" G	1" G	38,1	18
K 66/100 T	60146067	3 x 230 - 400 V ~	4,7	3	4	14,6-8,4			73				70	67,5	64	60,5	57	49	47						1½" G	1" G	40,7	18
K 90/100 T	60146068	3 x 230 - 400 V ~	5,4	4	5,5	16,5-9,5			83,5				82	79,5	76,5	72,5	68	61	58						1½" G	1" G	44	18

\* Star (Δ) starting is possible

## K - TWIN IMPELLERS CENTRIFUGAL - SINGLE-PHASE

MODEL	CODE	ELECTRICAL DATA					HYDRAULIC DATA																	DNA	DNM	Kg	Q.TY x PALLET														
		VOLTAGE 50 Hz	P1 MAX kW	P2 NOMINAL		In A	Q=m³/h																																		
				kW	HP		0	1,2	1,8	2,4	3,6	4,8	6	7,2	9	9,6	10,8	12	15	18	24	30	0					20	30	40	60	80	100	120	150	160	180	200	250	300	400
K 55/100 M	60152448	1 x 230	3,4	2,2	3	14,9	H (m)	62			59,5	57	54,5	51	47	39	36																					1½" G	1" G	38,1	18
K 66/100 M	60152449	1 x 230	4,4	3	4	19,5		73				70	67,5	64	60,5	57	49	47																				1½" G	1" G	40,7	18
K 90/100 M	60152450	1 x 230	5,0	4	5,5	21,9		83,5				82	79,5	76,5	72,5	68	61	58																				1½" G	1" G	44	18

# NKM-G / NKP-G

STANDARDISED ENBLOC CENTRIFUGAL PUMPS



Enbloc centrifugal electric pumps with integral shaft designed for a wide range of applications, such as:

- Water supply
- Circulation of hot water for central heating.
- Circulation of cold water for air conditioning and refrigerating.
- Transfer of liquids in agriculture, horticulture and industries.
- Implementation of pumping systems

#### Pump construction characteristics:

Single-stage, cast iron spiral body made to DIN-EN 733 (formerly DIN 24255), cast iron support, flanges in accordance with DIN 2533. Cast iron impeller, encased and dynamically balanced with compensation of the axial thrust by means of balancing holes, operating (on request) with interchangeable consumable rings. AISI 304 stainless steel pump shaft.

Seal: standardised mechanical seal made to DIN 24960 in carbon / carborundum with O' rings in EPDM.

#### Motor construction characteristics

Closed, asynchronous motor with external ventilation, 2 poles for NKP and 4 poles for NKM. Rotor mounted on oversized ball bearings to ensure silent running and long life. We recommend using overload protection for the motor, in accordance with current norms. In the case of liquids denser than water, the motors must be proportionally more powerful.

**Built to** IEC 2-3 standards

**Protection level** IP 55

**Insulation level** F

**Standard voltage** 230/400 V 50 Hz up to 2,2 Kw included 400 V Δ 50 Hz over 2,2 Kw

**Speed of rotation** 1450 - 2900 1/min.

#### Operating range

from 1 to 105 m<sup>3</sup>/h with head up to 96 metres.

**Characteristics of pumped liquid** clean, free from solids or abrasive substances, not viscous, not aggressive, not crystallised and chemically neutral and close to the characteristics of water.

#### Liquid temperature range

from -10°C to +140°C

**Maximum ambient temperature** +40°C

#### Maximum operating pressure

16 bar - 1600 kPa

**Flanging** PN 16 DIN 2533

**Installation** normally horizontal or vertical provided the motor is always above the pump.

#### Special versions on request

pumps for liquids other than water.  
Other voltages and/or frequencies.

IE3 ≥ 0,75 kW

ACCESSORIES  
PAG. 205

## NKM-G - STANDARDISED ENBLOC - 4 POLES

**CAST IRON IMPELLER**  
**> 1450 1/min**

MODEL	CODE	ELECTRICAL DATA					HYDRAULIC DATA								DNA	DNM	WEIGHT KG								
		VOLTAGE 50 Hz	P2 NOMINAL		In (A)		Q=m <sup>3</sup> /h	0	6	12	18	24	30	36				Q=1/min	0	100	200	300	400	500	600
			kW	HP	230V	400V	H (m)																		
NKM-G 32-125.1/140/A/BAQE/0.25/4	1D1K11BX3	3 x 230 - 400 V ~	0.25	0.33	1,56	0,9	6.2	5.8	4.2						50	32	32,8								
NKM-G 32-125/142/A/BAQE/0.37/4	1D1111B13	3 x 230 - 400 V ~	0.37	0.5	1,69	1	7	6.75	5.85	4.2					50	32	33,5								
NKM-G 32-160.1 169/A/BAQE/0.37/4	1D1L11B13	3 x 230 - 400 V ~	0.37	0.5	1,69	1	8.9	8.2	4.6					50	32	35,6									
NKM-G 32-160/169/A/BAQE/0,55/4	1D1211B23	3 x 230 - 400 V ~	0.55	0.75	2,6	1,5	9.4	9	7.9	5.6				50	32	39,8									
NKM-G 32-200.1 200/A/BAQE/0,55/4	1D1M11B23	3 x 230 - 400 V ~	0.55	0.75	2,6	1,5	12.7	11.2	7.2					50	32	45									
NKM-G 32-200/200/A/BAQE/0,75/4	1D1311B3W	3 x 230 - 400 V ~	0.75	1	3,12	1,8	13	12.5	11.1	8.45				50	32	42									
NKM-G 32-200/219/A/BAQE/1,1/4	1D1311B4W	3 x 230 - 400 V ~	1.1	1.5	4,33	2,5	16	15.4	14.3	12.2				50	32	41									
NKM-G 40-125/115/A/BAQE/0.25/4	1D2111BX3	3 x 230 - 400 V ~	0.25	0.33	1,56	0,9	4.2	4.1	3.7	3	2.1			65	40	34,2									
NKM-G 40-125/130/A/BAQE/0.37/4	1D2111B13	3 x 230 - 400 V ~	0.37	0.5	1,69	1	5.4	5.3	5.	4.4	3.5			65	40	35,3									
NKM-G 40-125/142/A/BAQE/0.55/4	1D2111B23	3 x 230 - 400 V ~	0.55	0.75	2,60	1,5	6.6	6.5	6.2	5.7	4.8			65	40	39,4									
NKM-G 40-160/153/A/BAQE/0.55/4	1D2211B23	3 x 230 - 400 V ~	0.55	0.75	2,60	1,5	7.6	7.6	7.5	6.7	5.5			65	40	40									
NKM-G 40-160/166/A/BAQE/0.75/4	1D2211B3W	3 x 230 - 400 V ~	0.75	1	3,12	1,8	9.2	9.2	9	8.4	7.4	5.7		65	40	35									
NKM-G 40-200/200/A/BAQE/1,1/4	1D2311B4W	3 x 230 - 400 V ~	1.1	1.5	4,3	2,5	12.5	12.5	12.3	11.2	9.7	7.7		65	40	41									
NKM-G 40-200/219/A/BAQE/1,5/4	1D2311B5W	3 x 230 - 400 V ~	1.5	2	6,24	3,6	15.6	15.6	15.3	14.7	13.4	11.8	9.8	65	40	42									
NKM-G 40-250/245/A/BAQE/2,2/4	1D2411B6W	3 x 230 - 400 V ~	2.2	3	10,22	5,9	20.6	20.5	20.1	19.2	17.8	16		65	40	63									
NKM-G 40-250/260/A/BAQE/3/4	1D2411B7X	3 x 400 V ~	3	4	-	6,8	23.3	23.1	22.8	22.2	20.8	19		65	40	59									

# NKM-G

STANDARDISED ENBLOC CENTRIFUGAL PUMPS



## NKM-G - STANDARDISED ENBLOC - 4 POLES

CAST IRON IMPELLER

> 1450 1/min

MODEL	CODE	ELECTRICAL DATA				HYDRAULIC DATA																DNA	DNM	KG				
		VOLTAGE 50 Hz	P2 NOMINAL		In (A)		Q=m³/h	0	12	18	24	30	36	42	48	54	60	66	72	78	84				90	102	114	
			kW	HP	230V	400V																						Q=l/min
NKM-G 50-125/130/A/ BAQE/0.55/4	1D3111B23	3 x 230 - 400 V ~	0.55	0.75	2,60	1,5		5.5	5.2	5	4.7	4.3	3.9	3.3	2.6											65	50	43
NKM-G 50-125/141/A/ BAQE/0.75/4	1D3111B3W	3 x 230 - 400 V ~	0.75	1	3,12	1,8		6.5	6.3	6.1	5.8	5.5	5	4.5	3.9											65	50	37
NKM-G 50-160/161/A/ BAQE/1.1/4	1D3211B4W	3 x 230 - 400 V ~	1.1	1.5	4,33	2,5		8.6	8.6	8.5	8.2	7.8	7.3	6.7	5.7											65	50	37
NKM-G 50-160/177/A/ BAQE/1,5/4	1D3211B5W	3 x 230 - 400 V ~	1.5	2	6,24	3,6		10.7	10.7	10.7	10.5	10.2	9.8	9.2	8.3											65	50	35
NKM-G 50-200/210/A/ BAQE/2,2/4	1D3311B6W	3 x 230 - 400 V ~	2.2	3	10,22	5,9		15.3	15.3	15.2	14.8	14	13.3	12.1	10.8	9.4										65	50	55
NKM-G 50-200/219/A/ BAQE/3/4	1D3311B7X	3 x 400 V ~	3	4	-	6,8		16.8	16.8	16.5	16.1	15.5	14.6	13.6	12.4	10.9										65	50	52
NKM-G 50-250/263/A/ BAQE/4/4	1D3411B8X	3 x 400 V ~	4	5.5	-	8,2		23.8	23.8	23.8	23.4	22.7	21.6	20.4	19	17.1										65	50	56
NKM-G 65-125/130/A/ BAQE/0.75/4	1D4111B3W	3 x 230 - 400 V ~	0.75	1	3,12	1,8		5.1	4.9	4.8	4.75	4.7	4.4	4.2	3.8	3.4	3	2.5								80	65	52
NKM-G 65-125/144/A/ BAQE/1.1/4	1D4111B4W	3 x 230 - 400 V ~	1.1	1.5	4,33	2,5	H (m)	6.5	6.4	6.4	6.3	6.2	6	5.75	5.5	5.1	4.65	4.2	3.75							80	65	39
NKM-G 65-160/153/A/ BAQE/1,1/4	1D4211B4W	3 x 230 - 400 V ~	1.1	1.5	4,33	2,5		7.4	7.4	7.3	7.15	6.9	6.65	6.25	5.8	5.3	4.4									80	65	42
NKM-G 65-160/165/A/ BAQE/1,5/4	1D4211B5W	3 x 230 - 400 V ~	1.5	2	6,24	3,6		8.9		8.8	8.7	8.6	8.3	8	7.6	7.15	6.6	6								80	65	40
NKM-G 65-160/177/A/ BAQE/2,2/4	1D4211B6W	3 x 230 - 400 V ~	2.2	3	10,22	5,9		10.5			10.4	10.3	10.2	9.9	9.6	9.2	8.75	8.2	7.4	6.6						80	65	52
NKM-G 65-200/210/A/ BAQE/3/4	1D4311B7X	3 x 400 V ~	3	4	-	6,8		15.3			15.2	15.2	15.1	14.6	14.1	13.5	12.9	12.2	11.3							80	65	56
NKM-G 65-200/219/A/ BAQE/4/4	1D4311B8X	3 x 400 V ~	4	5.5	-	8,2		17			17	16.9	16.8	16.4	16.2	15.8	15.2	14.3	13.8	12.6						80	65	58
NKM-G 65-250/263/A/ BAQE/5,5/4	1D4411B9X	3 x 400 V ~	5.5	7.5	-	10,6		24.1			23.8	23.6	23.3	22.8	22.3	21.5	20.8	19.7	18.6	17.3						80	65	142
NKM-G 65-315/279/A/ BAQE/7,5/4	1D4511BAX	3 x 400 V ~	7.5	10	-	14,4		27						26	25.5	25	24.5	23.6	22.7	21.5	20.2	19			80	65	163	
NKM-G 65-315/309/A/ BAQE/11/4	1D4511BBX	3 x 400 V ~	11	15	-	22,4		34.2						33.2	33	32.5	32	31.5	30.7	29.8	29	28	25	21.7	80	65	231	



# NKM-G

STANDARDISED ENBLOC CENTRIFUGAL PUMPS



## NKM-G - STANDARDISED ENBLOC - 4 POLES

**BRONZE IMPELLER**

> 1450 1/min

MODEL	CODE	ELECTRICAL DATA				HYDRAULIC DATA							DNA	DNM	KG				
		VOLTAGE 50 Hz	P2 NOMINAL		In (A)		Q=m³/h	0	6	12	18	24				30	36		
			kW	HP	230V	400V	Q=l/min	0	100	200	300	400				500	600		
NKM-G 32-125.1/ 140/B/BAQE/0.25/4	1D1K21BX3	3 x 230 - 400 V ~	0.25	0.33	1,56	0,9	H (m)d	6.2	5.8	4.2						50	32	32,8	
NKM-G 32-125/142/B/ BAQE/0.37/4	1D1121B13	3 x 230 - 400 V ~	0.37	0.5	1,69	1		7	6.75	5.85	4.2						50	32	33,5
NKM-G 32-160.1/ 169/B/BAQE/0.37/4	1D1L21B13	3 x 230 - 400 V ~	0.37	0.5	1,69	1		8.9	8.2	4.6							50	32	35,6
NKM-G 32-160/169/B/ BAQE/0,55/4	1D1221B23	3 x 230 - 400 V ~	0.55	0.75	2,6	1,5		9.4	9	7.9	5.6						50	32	39,8
NKM-G 32-200.1/200/B/ BAQE/0,55/4	1D1M21B23	3 x 230 - 400 V ~	0.55	0.75	2,6	1,5		12.7	11.2	7.2							50	32	45
NKM-G 32-200/200/B/ BAQE/0,75/4	1D1321B3W	3 x 230 - 400 V ~	0.75	1	3,12	1,8		13	12.5	11.1	8.45						50	32	42
NKM-G 32-200/219/B/ BAQE/1,1/4	1D1321B4W	3 x 230 - 400 V ~	1.1	1.5	4,33	2,5		16	15.4	14.3	12.2						50	32	41
NKM-G 40-125/115/B/ BAQE/0.25/4	1D2121BX3	3 x 230 - 400 V ~	0.25	0.33	1,56	0,9		4.2	4.1	3.7	3	2.1					65	40	34,2
NKM-G 40-125/130/B/ BAQE/0.37/4	1D2121B13	3 x 230 - 400 V ~	0.37	0.5	1,69	1		5.4	5.3	5	4.4	3.5					65	40	35,3
NKM-G 40-125/142/B/ BAQE/0.55/4	1D2121B23	3 x 230 - 400 V ~	0.55	0.75	2,60	1,5		6.6	6.5	6.2	5.7	4.8					65	40	39,4
NKM-G 40-160/153/B/ BAQE/0.55/4	1D2221B23	3 x 230 - 400 V ~	0.55	0.75	2,60	1,5		7.6	7.6	7.5	6.7	5.5					65	40	40
NKM-G 40-160/166/B/ BAQE/0.75/4	1D2221B3W	3 x 230 - 400 V ~	0.75	1	3,12	1,8		9.2	9.2	9	8.4	7.4	5.7				65	40	35
NKM-G 40-200/200/B/ BAQE/1,1/4	1D2321B4W	3 x 230 - 400 V ~	1.1	1.5	4,3	2,5		12.5	12.5	12.3	11.2	9.7	7.7				65	40	41
NKM-G 40-200/219/B/ BAQE/1,5/4	1D2321B5W	3 x 230 - 400 V ~	1.5	2	6,24	3,6		15.6	15.6	15.3	14.7	13.4	11.8	9.8			65	40	42
NKM-G 40-250/245/B/ BAQE/2,2/4	1D2421B6W	3 x 230 - 400 V ~	2.2	3	10,22	5,9		20.6	20.5	20.1	19.2	17.8	16				65	40	63
NKM-G 40-250/260/B/ BAQE/3/4	1D2421B7X	3 x 400 V ~	3	4	-	6,8		23.3	23.1	22.8	22.2	20.8	19				65	40	59



# NKM-G

STANDARDISED ENBLOC CENTRIFUGAL PUMPS



## NKM-G - STANDARDISED ENBLOC - 4 POLES

**BRONZE IMPELLER**

> 1450 1/min

MODEL	CODE	ELECTRICAL DATA				HYDRAULIC DATA																	DNA	DNM	KG					
		VOLTAGE 50 Hz	P2 NOMINAL		In (A)	Q=m³/h Q=l/min	0	30	36	42	48	54	60	66	72	78	84	90	102	114	120	150				180				
			kW	HP			230V	400V	0	500	600	700	800	900	1000	1100	1200	1300	1400	1500	1700	1900				2000	2500	3000		
NKM-G 80-160/153-136/B/ BAQE/1,5/4	1D5221B5W	3 x 230 - 400 V ~	1.5	2	6,24	3,6	H (m)	6.5	6.35	6.3	6.2	5.95	5.75	5.55	5.3	5	4.7	4.5	4.25	3.65	3						100	80	46	
NKM-G 80-160/163/B/ BAQE/2,2/4	1D5221B6W	3 x 230 - 400 V ~	2.2	3	10,22	5,9		8.65	8.5	8.45	8.3	8.15	7.9	7.7	7.4	7.2	6.9	6.65	6.3	5.7	4.9	4.6						100	80	61
NKM-G 80-160/177/B/ BAQE/3/4	1D5221B7X	3 x 400 V ~	3	4	-	6,8		10.2	10.2	10.1	10	9.9	9.75	9.65	9.5	9.25	9	8.8	8.6	7.9	7.2	6.7						100	80	58
NKM-G 80-200/200/B/ BAQE/4/4	1D5321B8X	3 x 400 V ~	4	5.5	-	8,2		13.2			13.1	13	12.9	12.8	12.7	12.4	12	11.7	11.3	10.4	9.3	8.7						100	80	84
NKM-G 80-200/222/B/ BAQE/5,5/4	1D5321B9X	3 x 400 V ~	5.5	7.5	-	10,6		16.6			16.5	16.5	16.4	16.2	16.1	16	15.7	15.4	15	14.3	13.3	12.7						100	80	130
NKM-G 80-250/240/B/ BAQE/7,5/4	1D5421BAX	3 x 400 V ~	7.5	10	-	14,4		20.4			20.3	20.3	20.2	20.1	20	19.9	19.8	19.5	19	18	16.7	16						100	80	153
NKM-G 80-250/270/B/ BAQE/11/4	1D5421BBX	3 x 400 V ~	11	15	-	22,4		25.6			25.5	25.5	25.4	25.1	25	24.8	24.6	24.2	24	23	21.5	21						100	80	205
NKM-G 80-315/305/B/ BAQE/15/4	1D5521BCX	3 x 400 V ~	15	20	-	30,5		32.9					32.7	32.6	32.6	32.5	32.4	32	31.6	30.5	29.5	28.9	24					100	80	263
NKM-G 80-315/320/B/ BAQE/18,5/4	1D5521BDX	3 x 400 V ~	18.5	25	-	34,3		36.8					36.7	36.6	36.6	36.5	36.5	36.5	36.1	35.5	34.5	34	29.5					100	80	275
NKM-G 80-315/334/B/ BAQE/22/4	1D5521BEX	3 x 400 V ~	22	30	-	40,2		41					40.8	40.8	40.7	40.6	40.6	40.4	40.2	39.8	39	38.5	34.8	29				100	80	298

MODEL	CODE	ELECTRICAL DATA				HYDRAULIC DATA																	DNA	DNM	KG					
		VOLTAGE 50 Hz	P2 NOMINAL		In (A)	Q=m³/h Q=l/min	0	60	66	72	78	84	90	102	114	120	150	180	210											
			kW	HP			0	1000	1100	1200	1300	1400	1500	1700	1900	2000	2500	3000	3500											
NKM-G100-200/ 200/B/BAQE/5,5/4	1D6321B9X	3 x 400 V ~	5.5	7.5	10,6	H (m)	12.7	12.6	12.6	12.5	12.5	12.4	12.3	12	11.5	11.4	10.1	8.5									125	100	142	
NKM-G100-200/ 214/B/BAQE/7,5/4	1D6321BAX	3 x 400 V ~	7.5	10	14,4		15.6	15.4	15.4	15.3	15.2	15.1	15	14.7	14.5	14.3	13.3	11.6	9.8								125	100	149	
NKM-G100-250/ 250/B/BAQE/11/4	1D6421BBX	3 x 400 V ~	11	15	22,4		21.1	21	21	21	21	21	21	20.9	20	19.8	18	16									125	100	213	
NKM-G100-250/ 270/B/BAQE/15/4	1D6421BCX	3 x 400 V ~	15	20	30,5		25.5	25.5	25.5	25.5	25.3	25.1	25.1	25	24.5	24	22.5	20.5	17.5									125	100	237
NKM-G100-315/ 300/B/BAQE/18,5/4	1D6521BDX	3 x 400 V ~	18.5	25	34,3		32					31.5	31.4	31	30.5	28.8	26	23										125	100	257
NKM-G100-315/ 316/B/BAQE/22/4	1D6521BEX	3 x 400 V ~	22	30	40,2		36					35.5	35.2	35	34.6	33.2	31	28	24									125	100	272

MODEL	CODE	ELECTRICAL DATA				HYDRAULIC DATA																	DNA	DNM	KG						
		VOLTAGE 50 Hz	P2 NOMINAL		In (A)	Q=m³/h Q=l/min	0	102	114	120	150	180	210	240	270	300	330	360	390	420											
			kW	HP			0	1700	1900	2000	2500	3000	3500	4000	4500	5000	5500	6000	6500	7000											
NKM-G125-250/ 243/B/BAQE/15/4	1D7421BCX	3 x 400 V ~	15	20	30,5	H (m)	19.5	19.3	19.3	19.2	19.2	18.7	17.8	16.8	15.5	14.1	12.5	10.9											150	125	274
NKM-G125-250/ 256/B/BAQE/18,5/4	1D7421BDX	3 x 400 V ~	18.5	25	34,3		21.9	21.8	21.8	21.7	21.6	21.3	20.5	19.5	18.5	17.2	15.6	14	12									150	125	290	
NKM-G125-250/ 266/B/BAQE/22/4	1D7421BEX	3 x 400 V ~	22	30	40,2		24.6	24.4	24.2	24.1	24	23.5	22.9	22	21	19.8	18.5	16.7	15									150	125	309	
NKM-G150-200/ 218/B/BAQE/11/4	1D8321BBX	3 x 400 V ~	11	15	22,4		13.2	13.1	13	13	12.8	12.5	12.1	11.5	11	10.4	9.7	9	8	7								150	125	280	

# NKM-G

STANDARDISED ENBLOC CENTRIFUGAL PUMPS



## NKP-G - STANDARDISED ENBLOC - 2 POLES

**CAST IRON IMPELLER**

> 2900 1/min

MODEL	CODE	ELECTRICAL DATA				HYDRAULIC DATA														DNA	DNM	KG	
		VOLTAGE 50 Hz	P2 NOMINAL		In (A)		Q=m³/h	0	6	12	18	24	30	36	42	48	54	60	66				72
			KW	HP	230V	400V	Q=l/min	0	100	200	300	400	500	600	700	800	900	1000	1100				1200
NKP-G 32-125.1/102/A/BAQE/0.75/2	1D1K11B3U	3 x 230 - 400 V ~	0,75	1	2,94	1,7	13	12.5	11	8											50	32	30
NKP-G 32-125.1/115/A/BAQE/1.1/2	1D1K11B4U	3 x 230 - 400 V ~	1,1	1.5	4,16	2,4	17.2	17	15	12.5											50	32	31
NKP-G 32-125.1/125/A/BAQE/1.5/2	1D1K11B5U	3 x 230 - 400 V ~	1,5	2	5,20	3	21	20.8	19	16.8											50	32	33
NKP-G 32-125.1/140/A/BAQE/2.2/2	1D1K11B6U	3 x 230 - 400 V ~	2,2	3	7,97	4,6	27	26.9	25.9	23	19.5										50	32	34
NKP-G 32-125/110/A/BAQE/1.1/2	1D1111B4U	3 x 230 - 400 V ~	1,1	1.5	4,16	2,4	15.8	15.2	14.5	12.9	9.9										50	32	28
NKP-G 32-125/120/A/BAQE/1.5/2	1D1111B5U	3 x 230 - 400 V ~	1,5	2	5,20	3	19.3	18.9	18.2	16.8	14.5										50	32	32
NKP-G 32-125/130/A/BAQE/2.2/2	1D1111B6U	3 x 230 - 400 V ~	2,2	3	7,97	4,6	23.6	23.1	23	21.6	19.6	16.8									50	32	34
NKP-G 32-125/142/A/BAQE/3/2	1D1111B7V	3 x 400 V ~	3,0	4	-	5,6	28.6	28	27.6	26.5	24.6	21.8	17.9								50	32	48
NKP-G 32-160.1 155/A/BAQE/2.2/2	1D1L11B6U	3 x 230 - 400 V ~	2,2	3	7,97	4,6	31.7	32.4	31	26.7											50	32	35
NKP-G 32-160.1 166/A/BAQE/3/2	1D1L11B7V	3 x 400 V ~	3,0	4	-	5,6	36.7	37.3	36.3	32.8	27										50	32	42
NKP-G 32-160.1 177/A/BAQE/4/2	1D1L11B8V	3 x 400 V ~	4	5,5	-	8,2	42.7	43.4	42.6	38.5	33.9										50	32	59
NKP-G 32-160/151/A/BAQE/3/2	1D1211B7V	3 x 400 V ~	3,0	4	-	5,6	30.5	30	29	27	24	19.5									50	32	45
NKP-G 32-160/163/A/BAQE/4/2	1D1211B8V	3 x 400 V ~	4,0	5,5	-	8,2	36.2	36	35	33.5	30.5	27	22								50	32	32
NKP-G 32-160/177/A/BAQE/5,5/2	1D1211B9V	3 x 400 V ~	5,5	7,5	-	10,2	43.5	43.2	42.6	41.5	39	36	31.5	25.5							50	32	51
NKP-G 32-200.1 188/A/BAQE/4/2	1D1M11B8V	3 x 400 V ~	4,0	5,5	-	8,2	45.3	44.4	40.8	34.4	26.8										50	32	38
NKP-G 32-200.1 205/A/BAQE/5,5/2	1D1M11B9V	3 x 400 V ~	5,5	7,5	-	10,2	56.6	55.7	52	45.8	36.2										50	32	54
NKP-G 32-200/190/A/BAQE/5.5/2	1D1311B9V	3 x 400 V ~	5,5	7,5	-	10,2	46.9	46.5	45	43	40	35	29								50	32	57
NKP-G 32-200/210/A/BAQE/7.5/2	1D1311BAV	3 x 400 V ~	7,5	10	-	14,4	58.8	58	57	56	53	49	44								50	32	96
NKP-G 40-125/107/A/BAQE/1.5/2	1D2111B5U	3 x 230 - 400 V ~	1,5	2	5,20	3	14.7	14.5	14.3	13.8	13	11.8	10.5	8.6	7						65	40	34
NKP-G 40-125/120/A/BAQE/2.2/2	1D2111B6U	3 x 230 - 400 V ~	2,2	3	7,97	4,6	19	18.7	18.4	17.8	17	15.9	14.6	13	11						65	40	36
NKP-G 40-125/130/A/BAQE/3/2	1D2111B7V	3 x 400 V ~	3,0	4	-	5,6	22.8	22.5	22.3	22	21.2	20.2	19	17.4	15.5	13.5					65	40	47
NKP-G 40-125/139/A/BAQE/4/2	1D2111B8V	3 x 400 V ~	4,0	5,5	-	8,2	26.4	26.2	26	25.6	25	24	23	21.5	19.5	17.5	15				65	40	35
NKP-G 40-160/158/A/BAQE/5,5/2	1D2211B9V	3 x 400 V ~	5,5	7,5	-	10,2	33.7			34	33.4	32.4	31	29.5	27	24					65	40	51
NKP-G 40-160/172/A/BAQE/7,5/2	1D2211BAV	3 x 400 V ~	7,5	10	-	14,4	40.7			40.2	40.1	39.8	38.5	37.5	35.5	33	30	26.5			65	40	90
NKP-G 40-200/210/A/BAQE/11/2	1D2311BBV	3 x 400 V ~	11,0	15	-	19,7	57.1	57	57	56.8	56.5	56	55	53	50	47	43.5	39			65	40	170
NKP-G 40-250/230/A/BAQE/15/2	1D2411BCV	3 x 400 V ~	15,0	20	-	26,7	72.5			72.5	72	70	68	66	62.5	60	56	51.5			65	40	180
NKP-G 40-250/245/A/BAQE/18.5/2	1D2411BDV	3 x 400 V ~	18,5	25	-	33	83			83	82.5	81.5	80	77	74	71.5	67.5	63.5	58.5		65	40	192
NKP-G 40-250/260/A/BAQE/22/2	1D2411BEV	3 x 400 V ~	22,0	30	-	38,1	96			95	94.5	93.5	92	90	87.5	84	81	76.5	71.5		65	40	223

# NKM-G

STANDARDISED ENBLOC CENTRIFUGAL PUMPS



## NKP-G - STANDARDISED ENBLOC - 2 POLES

CAST IRON IMPELLER

> 2900 1/min

MODEL	CODE	ELECTRICAL DATA				HYDRAULIC DATA																				DNA	DNM	KG
		VOLTAGE 50 Hz	P2 NOMINAL		In A	Q=m³/h		0	24	30	36	42	48	54	60	66	72	78	84	90	102	114	120	150				
			kW	HP		Q=l/min	0	400	500	600	700	800	900	1000	1100	1200	1300	1400	1500	1700	1900	2000	2500					
NKP-G 50-125/115/A/ BAQE/3/2	1D3111B7V	3 x 400 V ~	3,0	4	5,6	H (m)	17	16.5	16	15.5	15	14.5	13.7	13	12	11	10	9							65	50	48	
NKP-G 50-125/125/A/ BAQE/4/2	1D3111B8V	3 x 400 V ~	4,0	5.5	8,2		20.5	20	19.5	19.1	18.5	18	17.5	16.5	15.8	14.8	14	12.5	11.5							65	50	42
NKP-G 50-125/135/A/ BAQE/5,5/2	1D3111B9V	3 x 400 V ~	5,5	7.5	10,2		24	23.6	23.5	23.2	22.8	22.2	21.5	21	20	19.1	18.5	17.5	16.5	13.4						65	50	53
NKP-G 50-125/144/A/ BAQE/7,5/2	1D3111BAV	3 x 400 V ~	7,5	10	14,4		28	27.8	27.5	27.3	27	26.5	25.8	25.3	24.5	23.5	23	21.5	20.5	18	15.5					65	50	87
NKP-G 50-160/153/A/ BAQE/7,5/2	1D3211BAV	3 x 400 V ~	7,5	10	14,4		31.9	31.5	31.5	31.5	31.2	31	30.5	29.5	28.5	27.5	26	25	23.5							65	50	64
NKP-G 50-160/169/A/ BAQE/11/2	1D3211BBV	3 x 400 V ~	11,0	15	19,7		39.6		39.5	39.3	39.1	39	38.5	38	37.2	36.5	35	34	32.5							65	50	96
NKP-G 50-200/200/A/ BAQE/15/2	1D3311BCV	3 x 400 V ~	15,0	20	26,7		55.1		54.7	54.6	54	53.5	52	51	49	47.5	45.5	43	41							65	50	176
NKP-G 50-200/210/A/ BAQE/18,5/2	1D3311BDV	3 x 400 V ~	18,5	25	33		61.7		61.7	61.6	61.5	60.5	59	58	56.5	55	53	51	48.5	43						65	50	187
NKP-G 50-200/219/A/ BAQE/22/2	1D3311BEV	3 x 400 V ~	22,0	30	38,1		67.7		67.5	67.4	66.5	66	65.5	64	62.5	61	59.5	57	55	50						65	50	218
NKP-G 50-250/230/A/ BAQE/22/2	1D3411BEV	3 x 400 V ~	22,0	30	38,1		73.6		73.2	73.1	72.8	72	71	68.5	67	65	62.5	60	57	49						65	50	223
NKP-G 50-250/257/A/ BAQE/30/2	1D3411BFV	3 x 400 V ~	30,0	40	52,1		93		92.5	92.3	92	91.5	91	89	87.5	86	83	81	78	72						65	50	351
NKP-G 65-125/120-110/A/ BAQE/4/2	1D4111B8V	3 x 400 V ~	4,0	5.5	8,2		16			15	14.6	14.2	13.7	13.3	12.8	12.3	12	11.4	10	8.5	8				80	65	40	
NKP-G 65-125/127/A/ BAQE/5,5/2	1D4111B9V	3 x 400 V ~	5,5	7.5	10,2		19.5			19	18.9	18.7	18.4	18.1	17.5	17.2	16.9	16.5	15.8	14.5	13	12				80	65	55
NKP-G 65-125/137/A/ BAQE/7,5/2	1D4111BAV	3 x 400 V ~	7,5	10	14,4		23.5			23.1	23	22.8	22.6	22.5	22	21.6	21.1	20.7	20.2	19	17.5	14.8	12			80	65	94
NKP-G 65-160/157/A/ BAQE/11/2	1D4211BBV	3 x 400 V ~	11,0	15	19,7		32.5					32.3	32	31.9	31.3	30.2	30	29.2	28.7	27	24.8	23.6				80	65	166
NKP-G 65-160/173/A/ BAQE/15/2	1D4211BCV	3 x 400 V ~	15,0	20	26,7		40.1					39.7	39.6	39.5	39.5	39	38.5	38.2	37.5	36	34.5	33.5	26.9			80	65	172
NKP-G 65-200/190/A/ BAQE/18,5/2	1D4311BDV	3 x 400 V ~	18,5	25	33		51.1					51	50.8	50.5	50	49	48.5	48	47.5	45	42.5	41				80	65	192
NKP-G 65-200/200/A/ BAQE/22/2	1D4311BEV	3 x 400 V ~	22,0	30	38,1		56.4					56.1	56.1	56	55.8	55.5	55	54.8	54.5	53	51	49				80	65	223
NKP-G 65-200/219/A/ BAQE/30/2	1D4311BFV	3 x 400 V ~	30,0	40	52,1		68.9					68.8	68.8	68.7	68.7	68.6	68.5	68.4	67.5	66	64	63.1	57			80	65	351

MODEL	CODE	ELECTRICAL DATA				HYDRAULIC DATA												DNA	DNM	KG						
		VOLTAGE 50 Hz	P2 NOMINAL		In A	Q=m³/h		0	90	102	114	120	150	180	210	240										
			kW	HP		Q=l/min	0	1500	1700	1900	2000	2500	3000	3500	4000											
NKP-G 80-160/147-127/A/ BAQE/11/2	1D5211BBV	3 x 400 V ~	11,0	15	19,7	H (m)	24	22	21.4	20.4	20	17.4	16.8	12										100	80	179
NKP-G 80-160/153/A/ BAQE/15/2	1D5211BCV	3 x 400 V ~	15,0	20	26,7		30.5	29	28.4	27.5	27	24.5	21.3	18.3										100	80	181
NKP-G 80-160/163/A/ BAQE/18,5/2	1D5211BDV	3 x 400 V ~	18,5	25	33		35.5	34.3	33.6	32.6	32.3	29.8	26.8	23.6	20									100	80	192
NKP-G 80-160/169/A/ BAQE/22/2	1D5211BEV	3 x 400 V ~	22,0	30	38,1		38.5	37.2	36.8	36	35.8	33.5	30.8	27.5	24									100	80	221
NKP-G 80-200/190/A/ BAQE/30/2	1D5311BFV	3 x 400 V ~	30,0	40	52,1		48.3	47.9	47.6	47.5	47.3	44.7	41	36	29									100	80	374

# NKP-G

STANDARDISED ENBLOC CENTRIFUGAL PUMPS



## NKP-G - STANDARDISED ENBLOC - 2 POLES

**BRONZE IMPELLER**

> 2900 1/min

MODEL	CODE	ELECTRICAL DATA				HYDRAULIC DATA																DNA	DNM	KG
		VOLTAGE 50 Hz	P2 NOMINAL		In (A)	Q=m³/h	0	6	12	18	24	30	36	42	48	54	60	66	72					
			kW	HP			230V	400V	0	100	200	300	400	500	600	700	800	900	1000	1100	1200			
NKP-G 32-125.1/102/B/ BAQE/0.75/2	1D1K21B3U	3 x 230 - 400 V ~	0,75	1	2,94	1,7		13	12,5	11	8											50	32	30
NKP-G 32-125.1/115/B/ BAQE/1.1/2	1D1K21B4U	3 x 230 - 400 V ~	1,1	1,5	4,16	2,4		17,2	17	15	12,5											50	32	31
NKP-G 32-125.1/125/B/ BAQE/1.5/2	1D1K21B5U	3 x 230 - 400 V ~	1,5	2	5,20	3		21	20,8	19	16,8											50	32	33
NKP-G 32-125.1/140/B/ BAQE/2.2/2	1D1K21B6U	3 x 230 - 400 V ~	2,2	3	7,97	4,6		27	26,9	25,9	23	19,5										50	32	34
NKP-G 32-125/110/B/ BAQE/1.1/2	1D1121B4U	3 x 230 - 400 V ~	1,1	1,5	4,16	2,4		15,8	15,2	14,5	12,9	9,9										50	32	28
NKP-G 32-125/120/B/ BAQE/1.5/2	1D1121B5U	3 x 230 - 400 V ~	1,5	2	5,20	3		19,3	18,9	18,2	16,8	14,5										50	32	32
NKP-G 32-125/130/B/ BAQE/2.2/2	1D1121B6U	3 x 230 - 400 V ~	2,2	3	7,97	4,6		23,6	23,1	23	21,6	19,6	16,8									50	32	34
NKP-G 32-125/142/B/ BAQE/3/2	1D1121B7V	3 x 400 V ~	3,0	4	-	5,6		28,6	28	27,6	26,5	24,6	21,8	17,9								50	32	48
NKP-G 32-160.1 155/B/ BAQE/2.2/2	1D1L21B6U	3 x 230 - 400 V ~	2,2	3	7,97	4,6		29,2	29	26,5	20,5											50	32	35
NKP-G 32-160.1 166/B/ BAQE/3/2	1D1L21B7V	3 x 400 V ~	3,0	4	-	5,6		35,3	35	33	28											50	32	42
NKP-G 32-160.1 177/B/ BAQE/4/2	1D1L21B8V	3 x 400 V ~	4	5,5	-	8,2		42,7	43,4	42,6	38,5	33,9										50	32	59
NKP-G 32-160/151/B/ BAQE/3/2	1D1221B7V	3 x 400 V ~	3,0	4	-	5,6		30,5	30	29	27	24	19,5									50	32	45
NKP-G 32-160/163/B/ BAQE/4/2	1D1221B8V	3 x 400 V ~	4,0	5,5	-	8,2		36,2	36	35	33,5	30,5	27	22								50	32	32
NKP-G 32-160/177/B/ BAQE/5,5/2	1D1221B9V	3 x 400 V ~	5,5	7,5	-	10,2		43,5	43,2	42,6	41,5	39	36	31,5	25,5							50	32	51
NKP-G 32-200.1 188/B/ BAQE/4/2	1D1M21B8V	3 x 400 V ~	4,0	5,5	-	8,2		45,3	44,4	40,8	34,4	26,8										50	32	38
NKP-G 32-200.1 205/B/ BAQE/5,5/2	1D1M21B9V	3 x 400 V ~	5,5	7,5	-	10,2		56,6	55,7	52	45,8	36,2										50	32	54
NKP-G 32-200/190/B/ BAQE/5,5/2	1D1321B9V	3 x 400 V ~	5,5	7,5	-	10,2		46,9	46,5	45	43	40	35	29								50	32	57
NKP-G 32-200/210/B/ BAQE/7,5/2	1D1321BAV	3 x 400 V ~	7,5	10	-	14,4		58,8	58	57	56	53	49	44								50	32	96
NKP-G 40-125/107/B/ BAQE/1.5/2	1D2121B5U	3 x 230 - 400 V ~	1,5	2	5,20	3		14,7	14,5	14,3	13,8	13	11,8	10,5	8,6	7						65	40	34
NKP-G 40-125/120/B/ BAQE/2.2/2	1D2121B6U	3 x 230 - 400 V ~	2,2	3	7,97	4,6		19	18,7	18,4	17,8	17	15,9	14,6	13	11						65	40	36
NKP-G 40-125/130/B/ BAQE/3/2	1D2121B7V	3 x 400 V ~	3,0	4	-	5,6		22,8	22,5	22,3	22	21,2	20,2	19	17,4	15,5	13,5					65	40	47
NKP-G 40-125/139/B/ BAQE/4/2	1D2121B8V	3 x 400 V ~	4,0	5,5	-	8,2		26,4	26,2	26	25,6	25	24	23	21,5	19,5	17,5	15				65	40	35
NKP-G 40-160/158/B/ BAQE/5,5/2	1D2221B9V	3 x 400 V ~	5,5	7,5	-	10,2		33,7			34	33,4	32,4	31	29,5	27	24					65	40	51
NKP-G 40-160/172/B/ BAQE/7,5/2	1D2221BAV	3 x 400 V ~	7,5	10	-	14,4		40,7			40,2	40,1	39,8	38,5	37,5	35,5	33	30	26,5			65	40	90
NKP-G 40-200/210/B/ BAQE/11/2	1D2321BBV	3 x 400 V ~	11,0	15	-	19,7		57,1	57	57	56,8	56,5	56	55	53	50	47	43,5	39			65	40	170
NKP-G 40-250/230/B/ BAQE/15/2	1D2421BCV	3 x 400 V ~	15,0	20	-	26,7		72,5			72,5	72	70	68	66	62,5	60	56	51,5			65	40	180
NKP-G 40-250/245/B/ BAQE/18,5/2	1D2421BDV	3 x 400 V ~	18,5	25	-	33		83			83	82,5	81,5	80	77	74	71,5	67,5	63,5	58,5		65	40	192
NKP-G 40-250/260/B/ BAQE/22/2	1D2421BEV	3 x 400 V ~	22,0	30	-	38,1		96			95	94,5	93,5	92	90	87,5	84	81	76,5	71,5		65	40	223

# NKP-G

STANDARDISED ENBLOC CENTRIFUGAL PUMPS



## NKP-G - STANDARDISED ENBLOC - 2 POLES

**BRONZE IMPELLER**

> 2900 1/min

MODEL	CODE	ELECTRICAL DATA				HYDRAULIC DATA																	DNA	DNM	KG	
		VOLTAGE 50 Hz	P2 NOMINAL		In A	Q=m³/h Q=l/min	0	24	30	36	42	48	54	60	66	72	78	84	90	102	114	120				150
			kW	HP			0	400	500	600	700	800	900	1000	1100	1200	1300	1400	1500	1700	1900	2000				2500
NKP-G 50-125/115/B/BAQE/3/2	1D3121B7V	3 x 400 V ~	3,0	4	5,6	17	16.5	16	15.5	15	14.5	13.7	13	12	11	10	9							65	50	48
NKP-G 50-125/125/B/BAQE/4/2	1D3121B8V	3 x 400 V ~	4,0	5.5	8,2	20.5	20	19.5	19.1	18.5	18	17.5	16.5	15.8	14.8	14	12.5	11.5						65	50	42
NKP-G 50-125/135/B/BAQE/5,5/2	1D3121B9V	3 x 400 V ~	5,5	7.5	10,2	24	23.6	23.5	23.2	22.8	22.2	21.5	21	20	19.1	18.5	17.5	16.5	13.4					65	50	53
NKP-G 50-125/144/B/BAQE/7,5/2	1D3121BAV	3 x 400 V ~	7,5	10	14,4	28	27.8	27.5	27.3	27	26.5	25.8	25.3	24.5	23.5	23	21.5	20.5	18	15.5				65	50	87
NKP-G 50-160/153/B/BAQE/7,5/2	1D3221BAV	3 x 400 V ~	7,5	10	14,4	31.9	31.5	31.5	31.5	31.2	31	30.5	29.5	28.5	27.5	26	25	23.5						65	50	64
NKP-G 50-160/169/B/BAQE/11/2	1D3221BBV	3 x 400 V ~	11,0	15	19,7	39.6		39.5	39.3	39.1	39	38.5	38	37.2	36.5	35	34	32.5						65	50	96
NKP-G 50-200/200/B/BAQE/15/2	1D3321BCV	3 x 400 V ~	15,0	20	26,7	55.1		54.7	54.6	54	53.5	52	51	49	47.5	45.5	43	41						65	50	176
NKP-G 50-200/210/B/BAQE/18,5/2	1D3321BDV	3 x 400 V ~	18,5	25	33	61.7		61.7	61.6	61.5	60.5	59	58	56.5	55	53	51	48.5	43					65	50	187
NKP-G 50-200/219/B/BAQE/22/2	1D3321BEV	3 x 400 V ~	22,0	30	38,1	67.7		67.5	67.4	66.5	66	65.5	64	62.5	61	59.5	57	55	50					65	50	218
NKP-G 50-250/230/B/BAQE/22/2	1D3421BEV	3 x 400 V ~	22,0	30	38,1	73.6		73.2	73.1	72.8	72	71	68.5	67	65	62.5	60	57	49					65	50	223
NKP-G 50-250/257/B/BAQE/30/2	1D3421BFV	3 x 400 V ~	30,0	40	52,1	93		92.5	92.3	92	91.5	91	89	87.5	86	83	81	78	72					65	50	351
NKP-G 65-125/120-110/B/BAQE/4/2	1D4121B8V	3 x 400 V ~	4,0	5.5	8,2	16			15	14.6	14.2	13.7	13.3	12.8	12.3	12	11.4	10	8.5	8			80	65	40	
NKP-G 65-125/127/B/BAQE/5,5/2	1D4121B9V	3 x 400 V ~	5,5	7.5	10,2	19.5			19	18.9	18.7	18.4	18.1	17.5	17.2	16.9	16.5	15.8	14.5	13	12		80	65	55	
NKP-G 65-125/137/B/BAQE/7,5/2	1D4121BAV	3 x 400 V ~	7,5	10	14,4	23.5			23.1	23	22.8	22.6	22.5	22	21.6	21.1	20.7	20.2	19	17.5	14.8	12	80	65	94	
NKP-G 65-160/157/B/BAQE/11/2	1D4221BBV	3 x 400 V ~	11,0	15	19,7	32.5					32.3	32	31.9	31.3	30.2	30	29.2	28.7	27	24.8	23.6		80	65	166	
NKP-G 65-160/173/B/BAQE/15/2	1D4221BCV	3 x 400 V ~	15,0	20	26,7	40.1					39.7	39.6	39.5	39.5	39	38.5	38.2	37.5	36	34.5	33.5	26.9	80	65	172	
NKP-G 65-200/190/B/BAQE/18,5/2	1D4321BDV	3 x 400 V ~	18,5	25	33	51.1					51	50.8	50.5	50	49	48.5	48	47.5	45	42.5	41		80	65	192	
NKP-G 65-200/200/B/BAQE/22/2	1D4321BEV	3 x 400 V ~	22,0	30	38,1	56.4					56.1	56.1	56	55.8	55.5	55	54.8	54.5	53	51	49		80	65	223	
NKP-G 65-200/219/B/BAQE/30/2	1D4321BFV	3 x 400 V ~	30,0	40	52,1	68.9					68.8	68.8	68.7	68.7	68.6	68.5	68.4	67.5	66	64	63.1	57	80	65	351	

MODEL	CODE	ELECTRICAL DATA				HYDRAULIC DATA											DNA	DNM	KG
		VOLTAGE 50 Hz	P2 NOMINAL		In A	Q=m³/h Q=l/min	0	90	102	114	120	150	180	210	240				
			kW	HP			0	1500	1700	1900	2000	2500	3000	3500	4000				
NKP-G 80-160/147-127/BAQE/11/2	1D5221BBV	3 x 400 V ~	11,0	15	19,7	24	22	21.4	20.4	20	17.4	16.8	12			100	80	179	
NKP-G 80-160/153/B/BAQE/15/2	1D5221BCV	3 x 400 V ~	15,0	20	26,7	30.5	29	28.4	27.5	27	24.5	21.3	18.3			100	80	181	
NKP-G 80-160/163/B/BAQE/18,5/2	1D5221BDV	3 x 400 V ~	18,5	25	33	35.5	34.3	33.6	32.6	32.3	29.8	26.8	23.6	20		100	80	192	
NKP-G 80-160/169/B/BAQE/22/2	1D5221BEV	3 x 400 V ~	22,0	30	38,1	38.5	37.2	36.8	36	35.8	33.5	30.8	27.5	24		100	80	221	
NKP-G 80-200/190/B/BAQE/30/2	1D5321BFV	3 x 400 V ~	30,0	40	52,1	48.3	47.9	47.6	47.5	47.3	44.7	41	36	29		100	80	374	